

INTERIOR DESIGN
PORTFOLIO

THIS PORTFOLIO GENERALLY EXHIBITS MY EXPERIENCE IN TWO YEARS OF STUDYING, WORKING AS AN INTERIOR DESIGNER & 3D ARTIST BESIDE SOME LATEST WORKS DURING THE PERIOD OF TIME.

My name is Tuong. I was born in Phan Rang which is a beautiful coastal city in Vietnam. When I was a child, I was extremely curious about surroundings, and wanted to discover them. I had a burning ambition how to bring universe's beauty back to the ordinary life. Therefore, I decided to devote my life to enjoying and understanding the roots of it. Currently, I am profoundly passionate about interior design which I believe might form a foundation for a greater life.

I am mesmerized by organic as well as parametric designs. Sexy curves and waves of the designs demonstrate generosity, flexibility and novelty in aesthetic awareness of the designers. A remarkable example is Tianjin Binhai Library in China which is chosen as source of inspiration for my prospect career.



LE KHANH CAT TUONG

✉ tuong.lkct0310@gmail.com

Behance www.behance.net/lkct0310

CONTENTS

Rices & Growth
A beauty from idylls

The eye of nature
Broaden your mind

The Gentleman
Perfume

The Perfect House

FDEV_02

Studying
Experience

Working
Experience

6

22

28

30

31

Your time is limited. So don't waste it
living someone else's life.
~ Steve Job ~

Rices & Growth

A beauty from idylls

Interior designing & visualizing

Project type: Hospitality design - Resort
Location: Phu Quoc Island, Vietnam
Date: January, 2019

This is my final project in HND level 5 after 2 years of studying interior design.

Stunning rice fields have a profound impact on my soul during my childhood. Every time I visit my hometown, while sitting on the train, I enjoy looking out through the window. The ever-changing scenery has given me an unexplainable feeling. So I decide to design a resort which was inspired by this signature moment.

The entire design concentrates on a little things from idylls where there are thousand miles of magnificent and peaceful rice fields. There are diligent farmers collecting their crops in hurry and kids playing some traditional games on the way to village. The scenery is emphasized by yellow and green fields, brown soil and wooden farming tools under the blue sky. Wishing to bring the typical beauty of Vietnamese rural areas to travelers in a distinctive way, I came up with this design to combine this beauty with contemporary style which create a transformation connecting the past to the future.

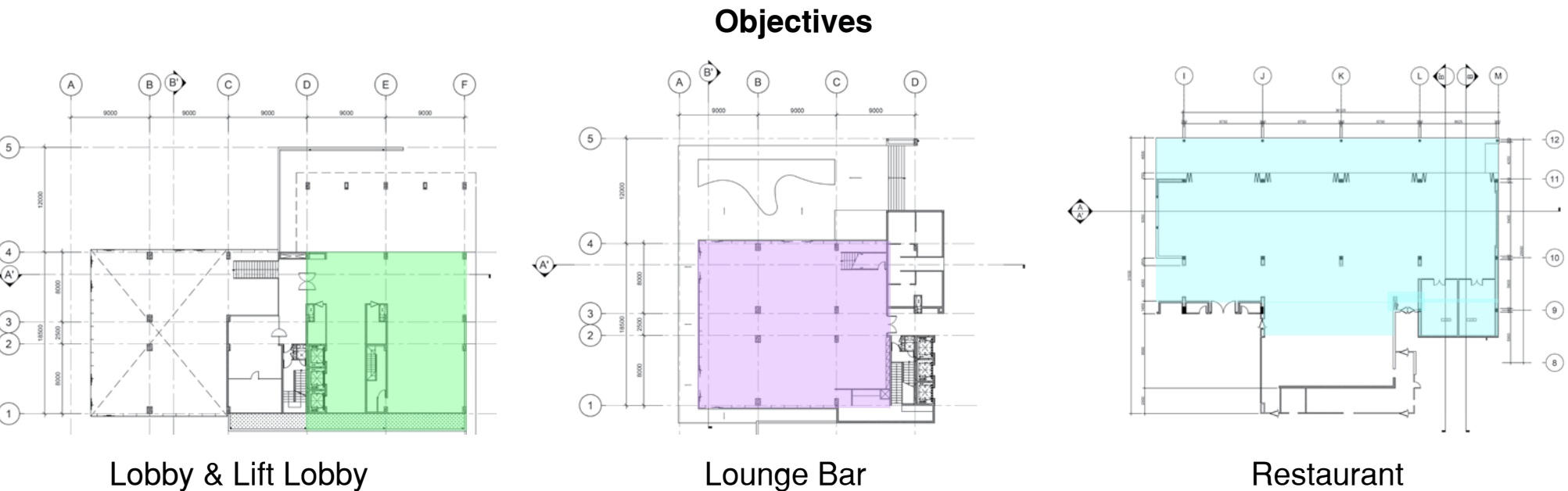

Location

SALINDA RESORT
PHU QUOC ISLAND

"A sparkling beachfront resort on the Vietnamese island paradise of Phu Quoc."

Situated on the virgin white sands of Vietnam's largest island, this sensational resort and spa is the pearl of Phu Quoc resorts. Just a 10-minute journey from the international airport, the resort blends traditional Asian charm with cutting edge design, all on a tropical island cloaked in verdant jungle and fringed by palm-studded beaches.

From the sleek pool and exhilarating water-sports, to the stylish fusion dining, Salinda Resort Phu Quoc Island is a luxurious sanctuary of self-indulgence. Meld mind, body and soul at the sensuous Spa, sip cool cocktails at the poolside bar, and explore rarely-seen coral reefs snorkelling or diving in some of Southeast Asia's most scenic waters.

Vietnamese rural areas

I picked out three main key words to demonstrate the soul of entire design.

I had ever been mesmerized by a fleeting moment that the wind gently swept through the silk dried on the meadow. For each second that passes with the gentle breeze, the form of a piece of fabric can change infinitely.

Peace, it is always the word to describe the state of an empty mind, without any daily thinking, stress or trouble. Sometimes, I really want to escape from daily life routines. Only by being at my hometown, i can feel at peace.

All of these are allways a remarkable feature to recollect in the future.

Peace

Flow

Recollection

General concept



Moodboard

Lobby & Lift lobby



Restaurant



Lounge Bar



Bubble diagram

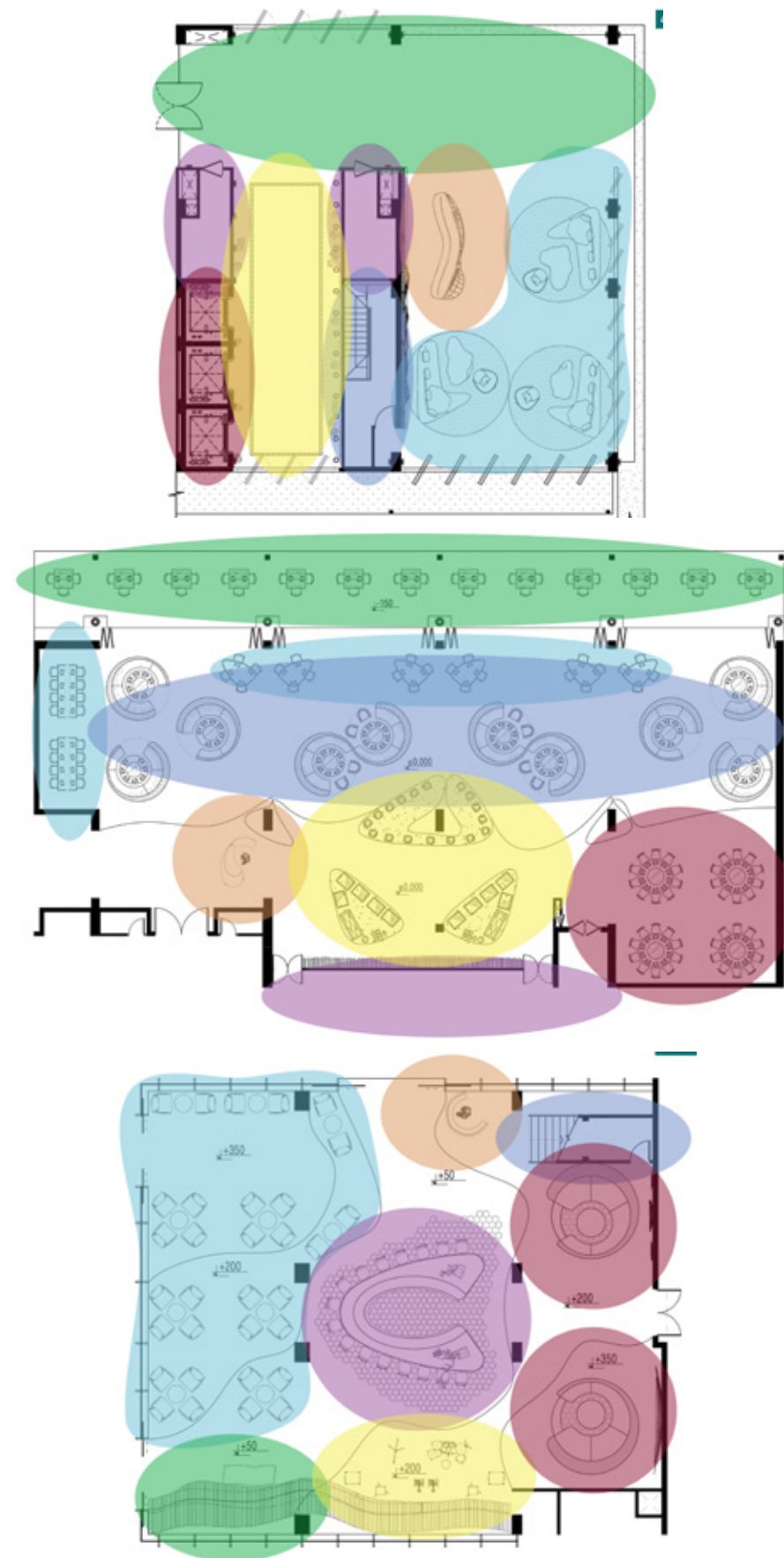

Public Utilities:	Area / Total:
Corridor	114 / 332 m2
Lounge	88 / 332 m2
Lift	15 / 332 m2
Lift Lobby	55 / 332 m2
Staircase	17 / 332 m2
Private Utilities:	Area / Total:
Reception	24 / 332 m2
Office	19 / 332 m2

Public Utilities:	Area / Total:
Outdoor	155 / 653 m2
Dinning	90 / 653 m2
Family	70 / 653 m2
Buffet	120 / 653 m2
Banquet	200 / 653 m2
Private Utilities:	Area / Total:
Reception	18 / 653 m2
Kitchen	...

Public Utilities:	Area / Total:
Tea	23 / 332 m2
Lounge	120 / 332 m2
VIP	70 / 332 m2
Stage	35 / 332 m2
Staircase	19 / 332 m2
Private Utilities:	Area / Total:
Reception	5 / 332 m2
Bar Counter	60 / 332 m2

Circulation plan

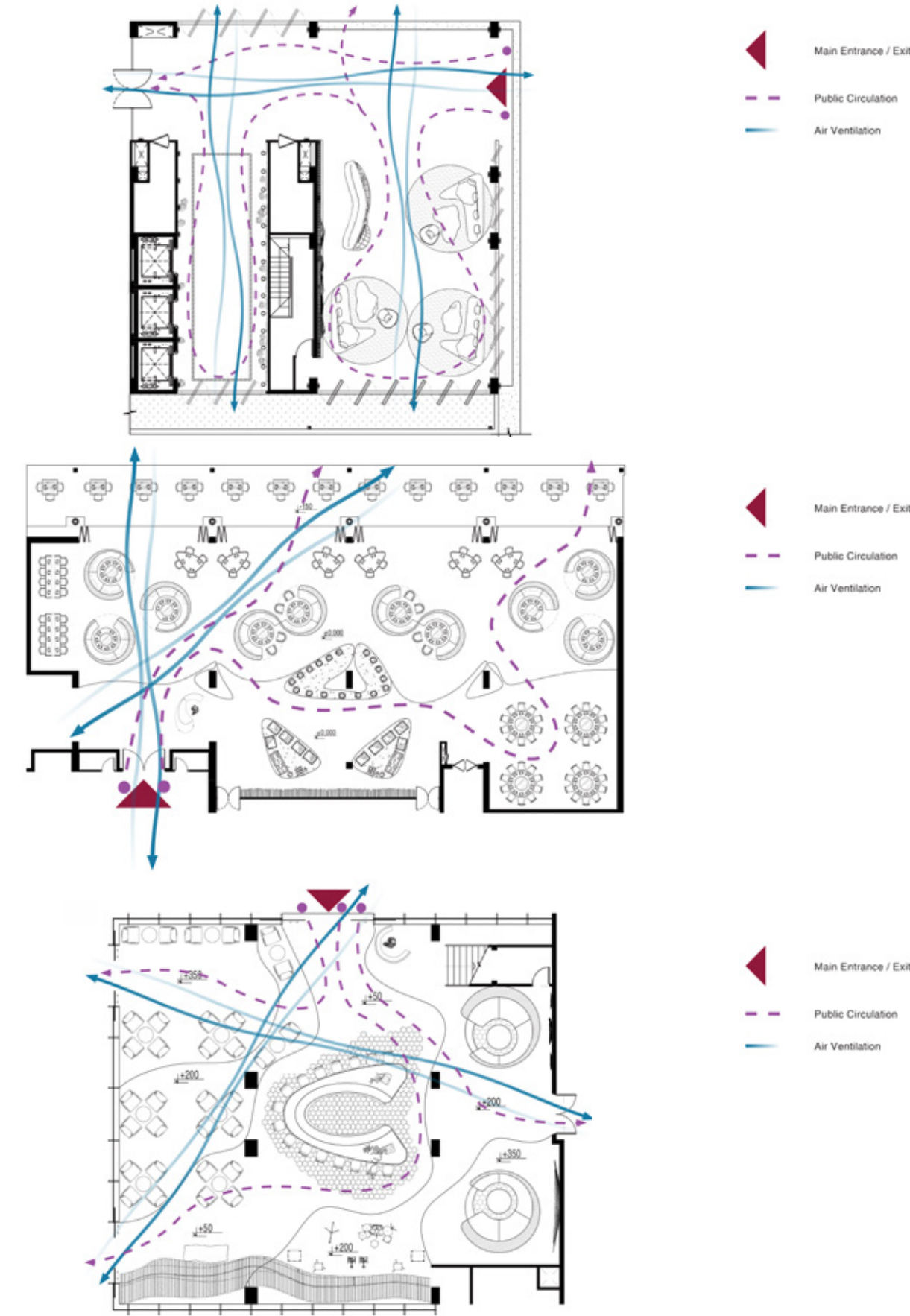

Lobby & Lift Lobby

The general design at lobby and lift lobby areas is demonstrated by organic square shapes from almost massive rice fields in Vietnam mixing with Vietnamese louver windows and a key element which is motion. Purple color from the dawn sky is chosen for an emphasized factor between brown and white background. Another notable figure can be illustrated by Vietnamese bamboo fish trap at lift lobby area is hanging lights.



This light simplifies bamboos on the way to villages and somewhere on the fields.

Louver window is remarkable feature in Vietnamese countryside because of cooling.

Wooden fan is used in many rural areas in Vietnam from past to present.

The ceiling is a combination of rectangle shape from rice fields and Vietnamese louver window concept.



The pattern ceramic tile was the material which was used by the vietnamese rich in the previous centuries.

The curves and organic rectangle shapes from rice fields are combined to create this reception counter.

This wooden panel illustrates the fleeting moment that the breeze gently swept through thousand of rice plants on the fields. It creates many massive waves continuously running to infinity.

This wooden square panel simplifies by the fields.

The hanging light is inspired by fish trap.

The ceiling behind is woven rattan with natural pattern which is a Vietnamese countryside signature.



Vietnamese Bamboo leaf conical hats which the famers usually use while working.

Lotus flower is one of the most famous symbols of Vietnamese daily life.

This kind of fabric is usually found in Vietnamese countryside.

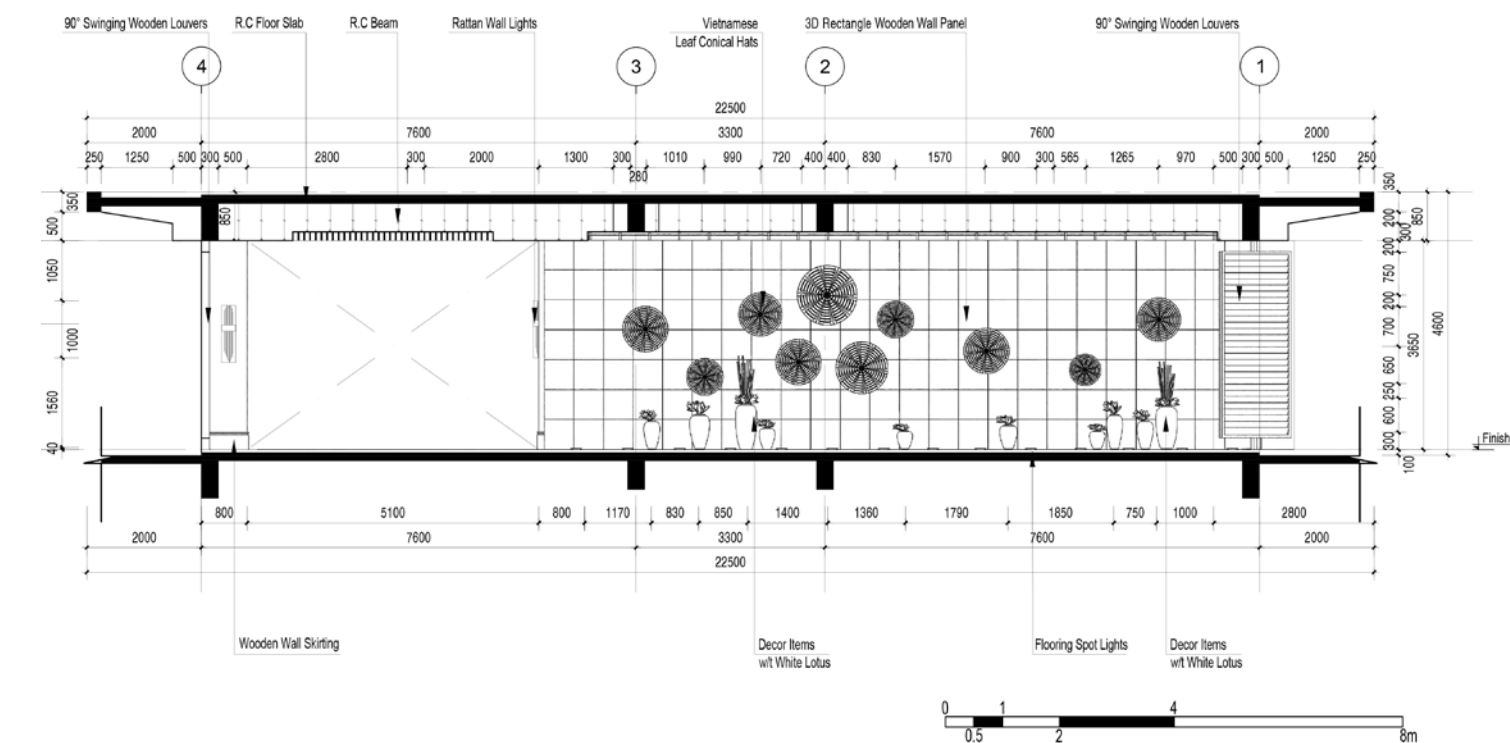
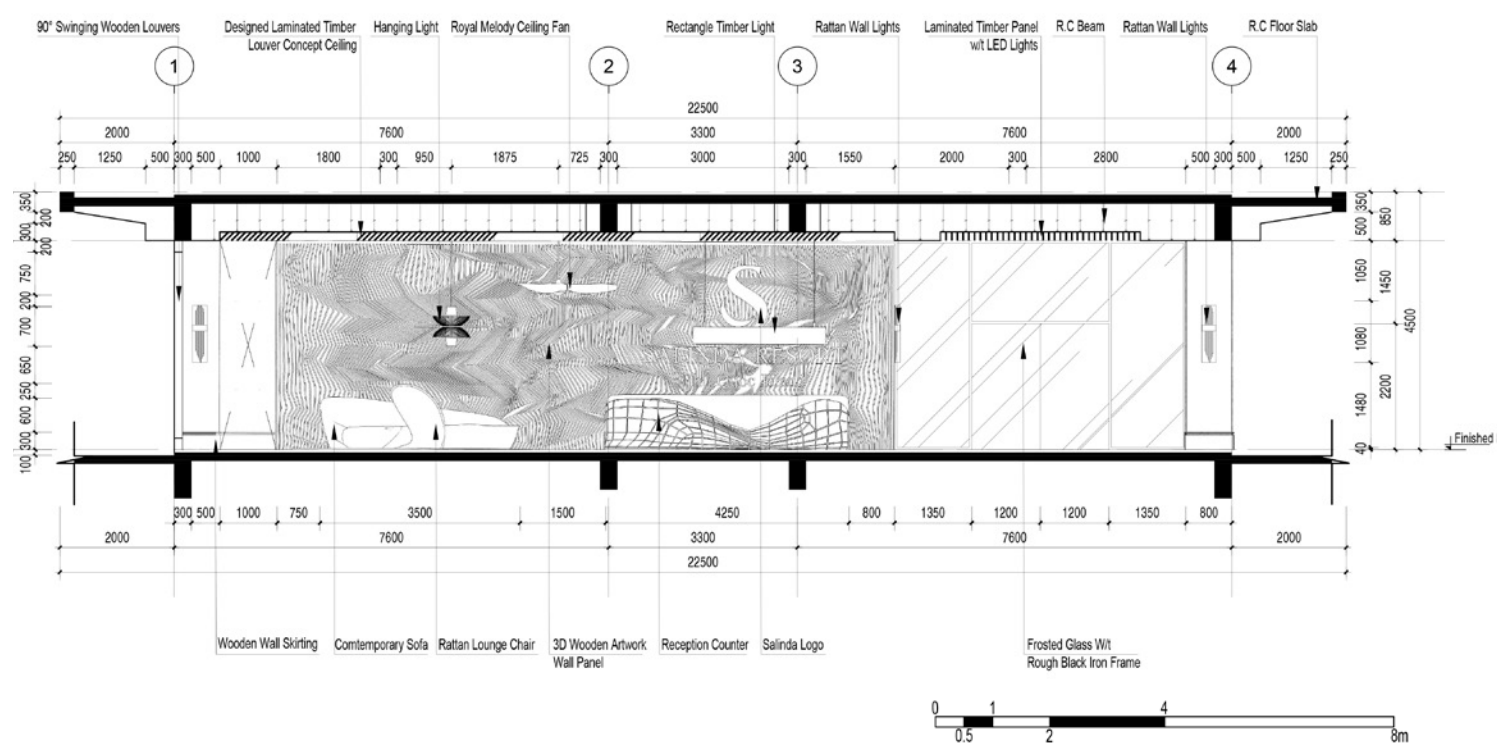
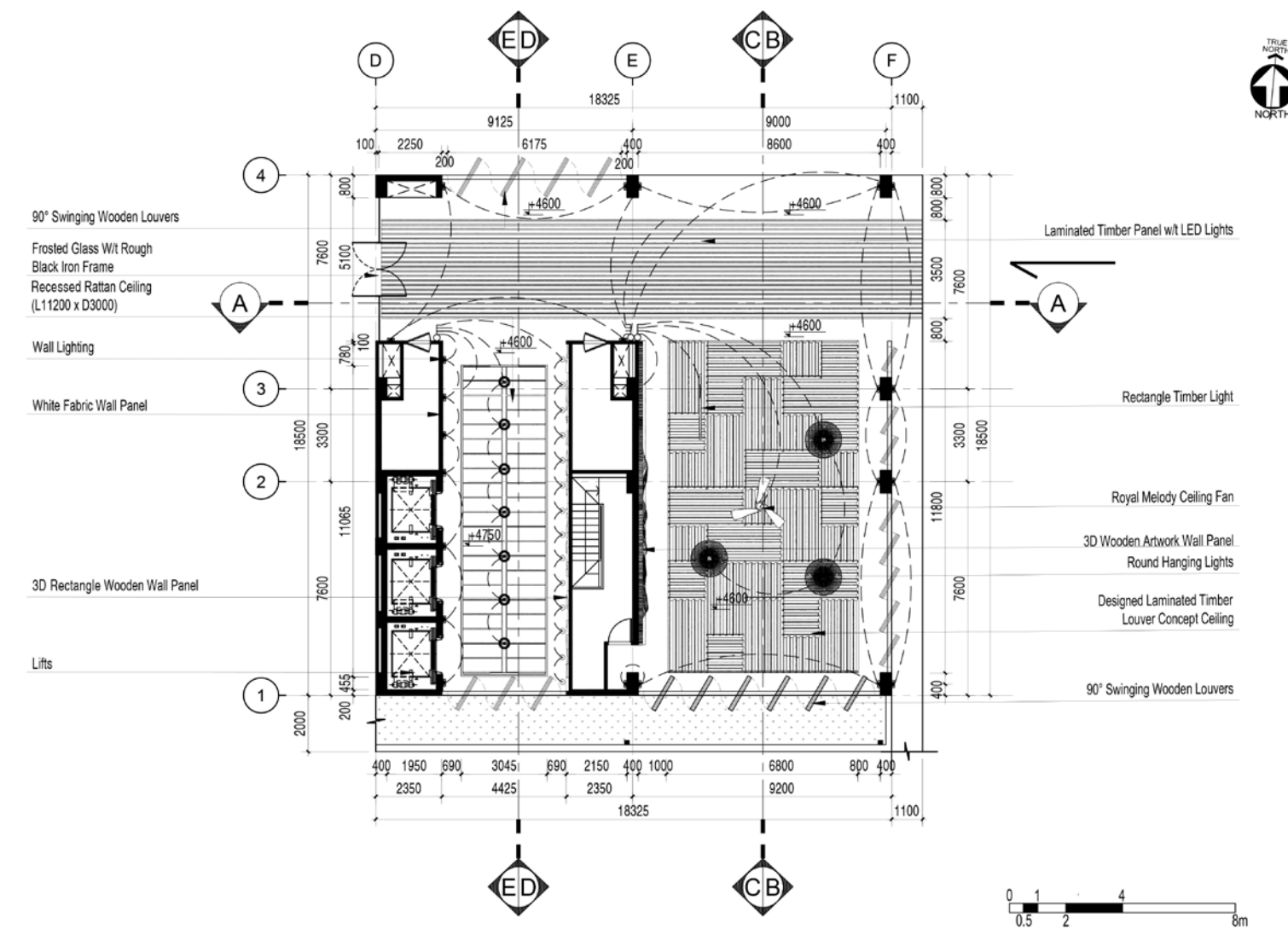
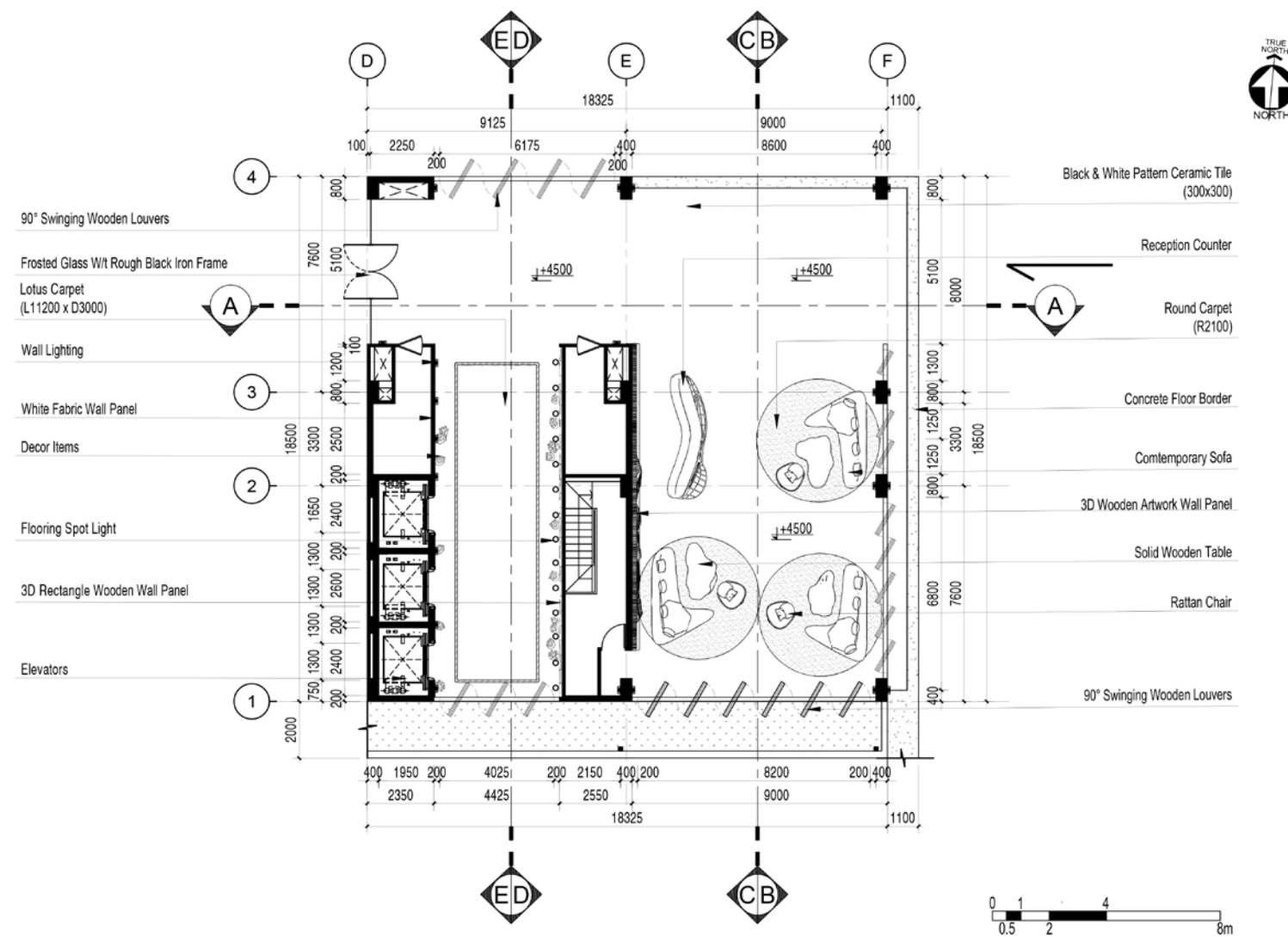





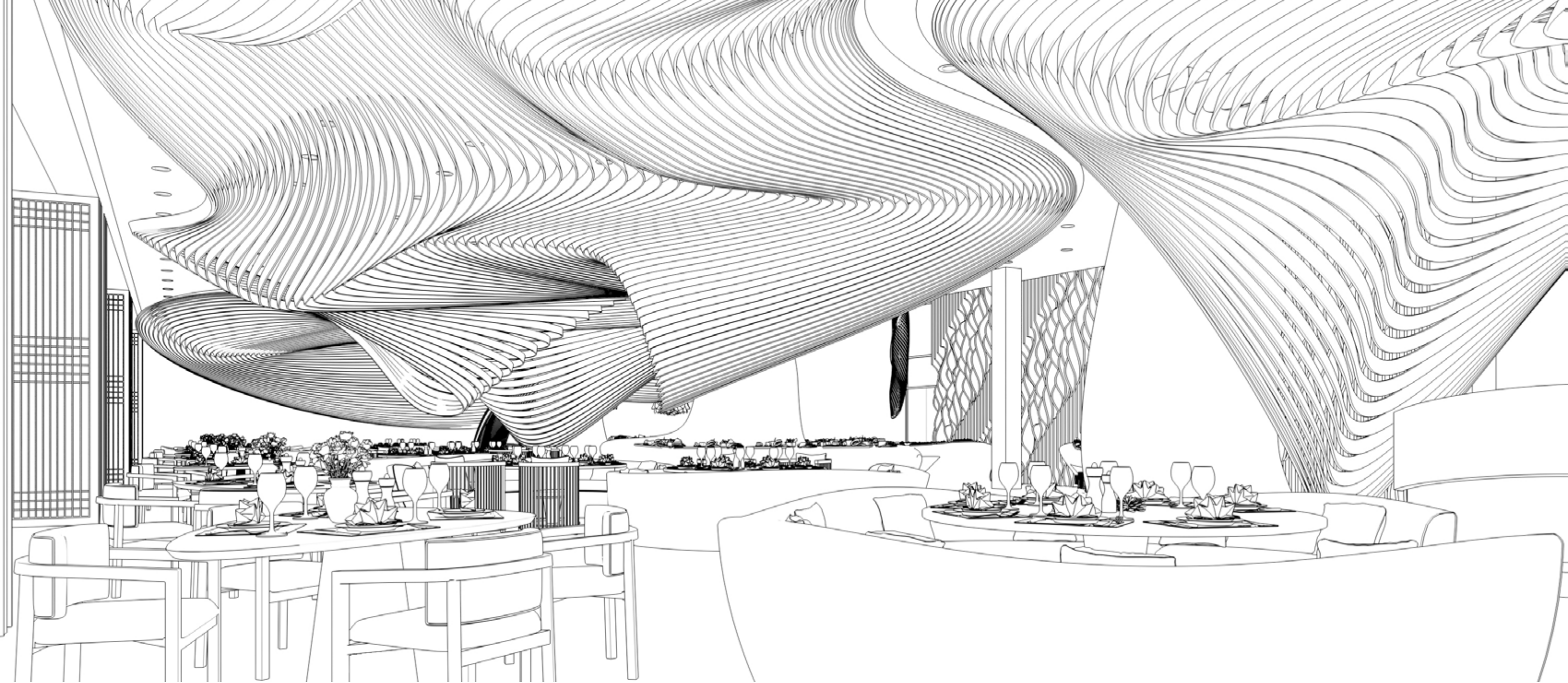

Restaurant

Vietnamese silks between the rice fields is deeply reflected on the design at restaurant with many curves and waves to create surrounding flows. Red and blue which stands for the sky and many hard-working farmers are chosen as a main feature for the entire scene.

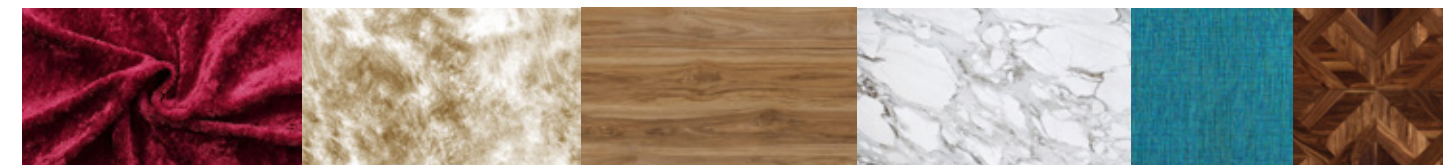

The ceiling behind has to be dark to emphasize the wooden ceiling below like a kind of light.

This ceiling is created by flywood for flexibility to demonstrate silk properties

Additionally notable feature of silk is sleekness which is shown by these columns and a part of the floor.

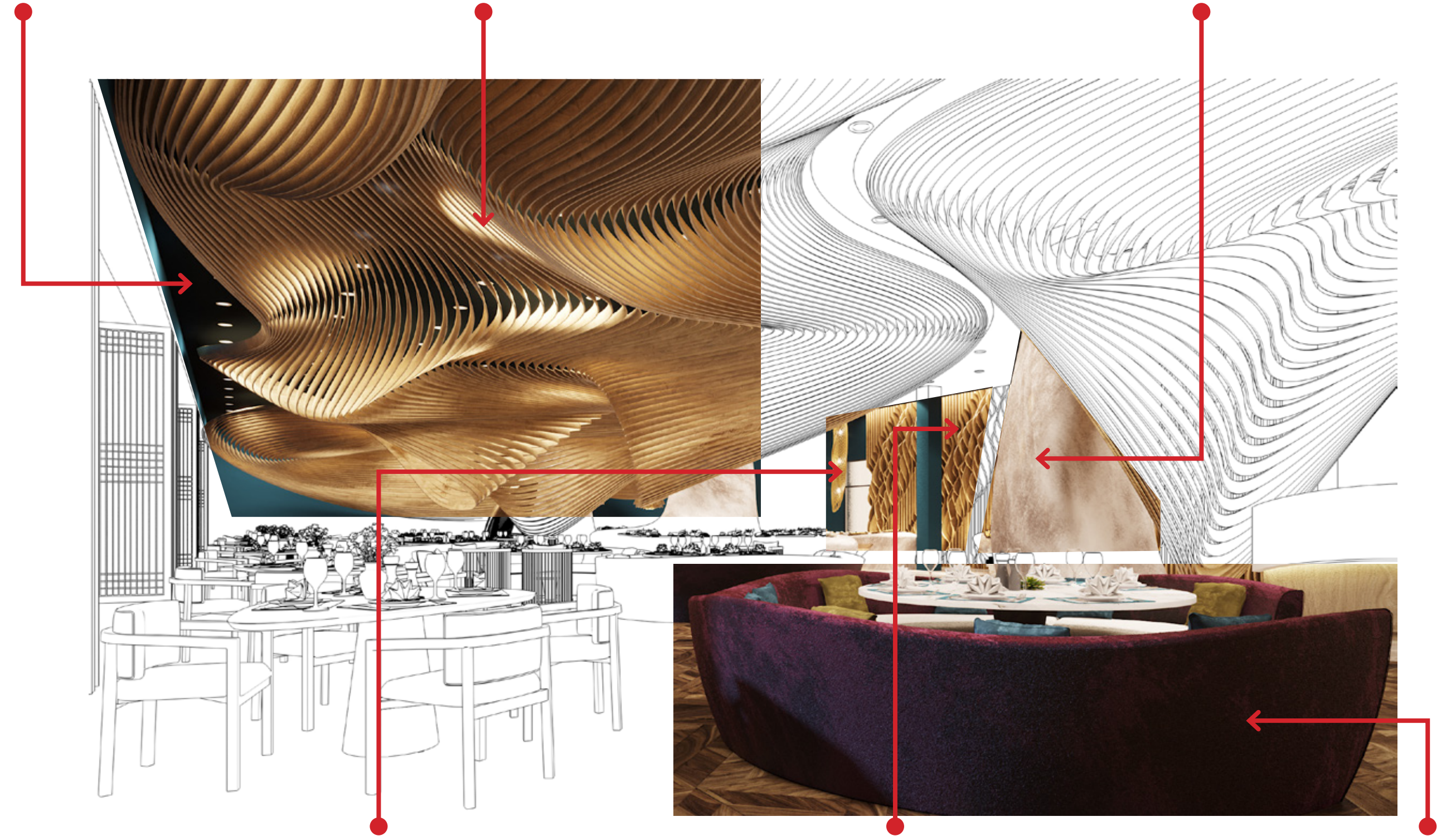

This light is inspired by beehive which a typical image in the countryside.

The panel demonstrates the rice plant concept

The round seating illustrates round woven baskets which are a typical tool to store collected rices. Their shape mix with velvet material to create a contemporary seating.

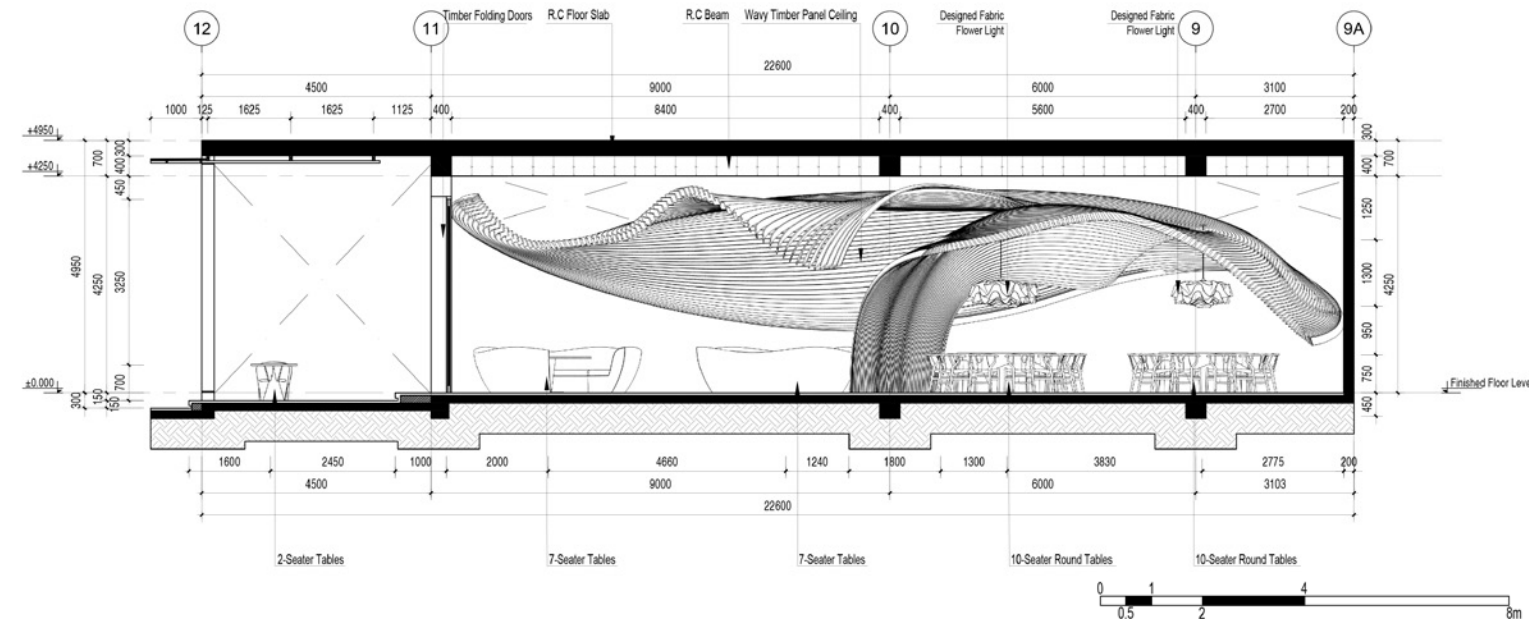
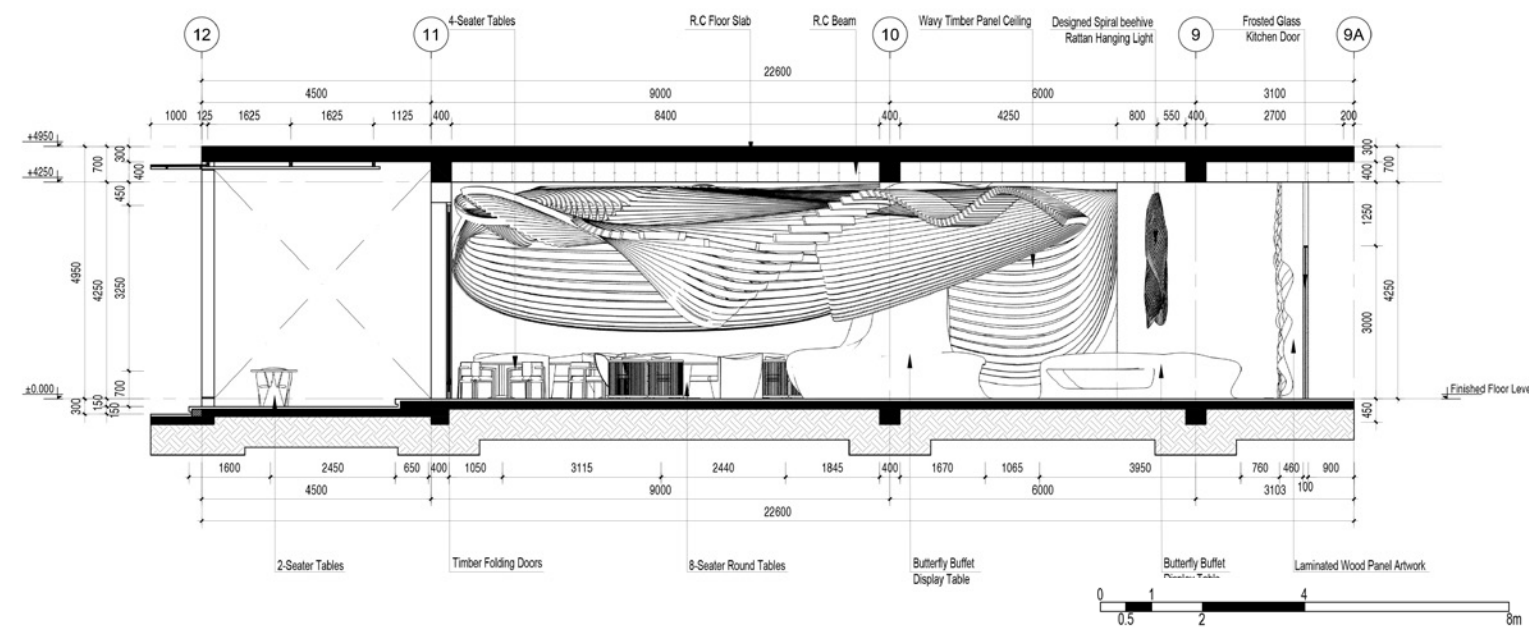
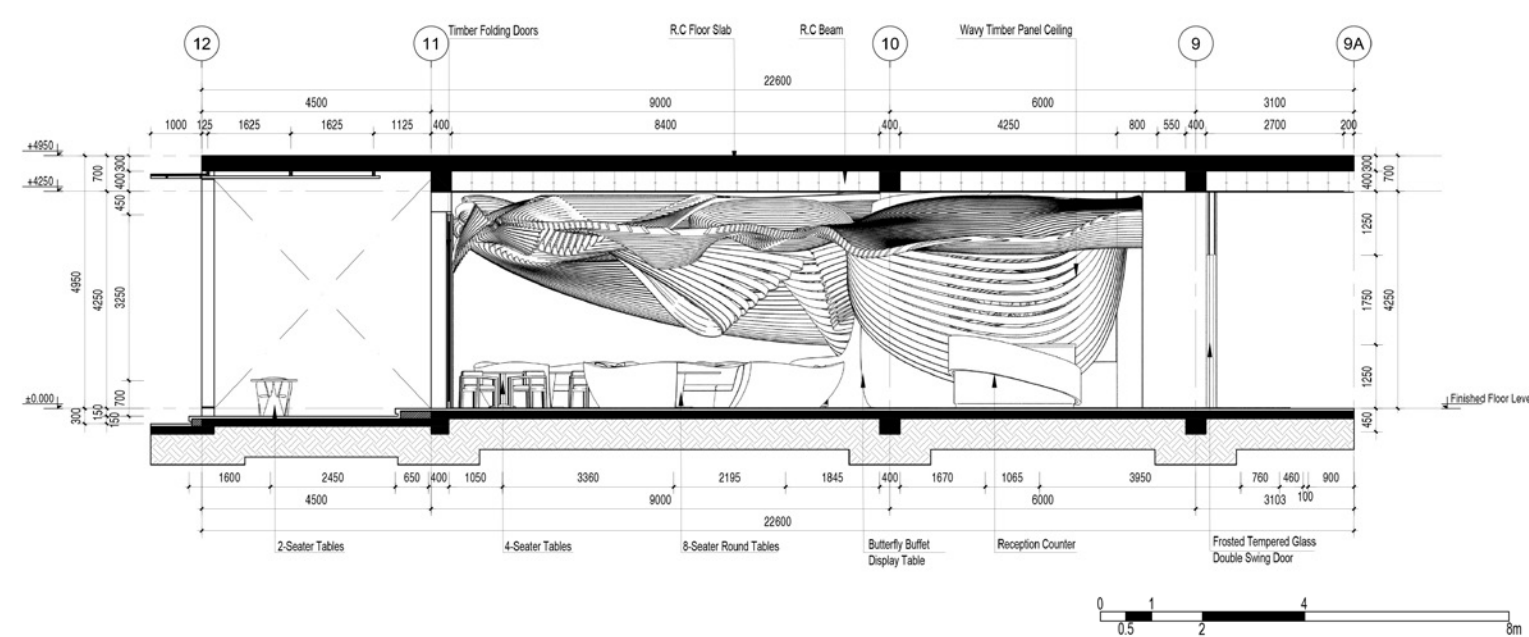
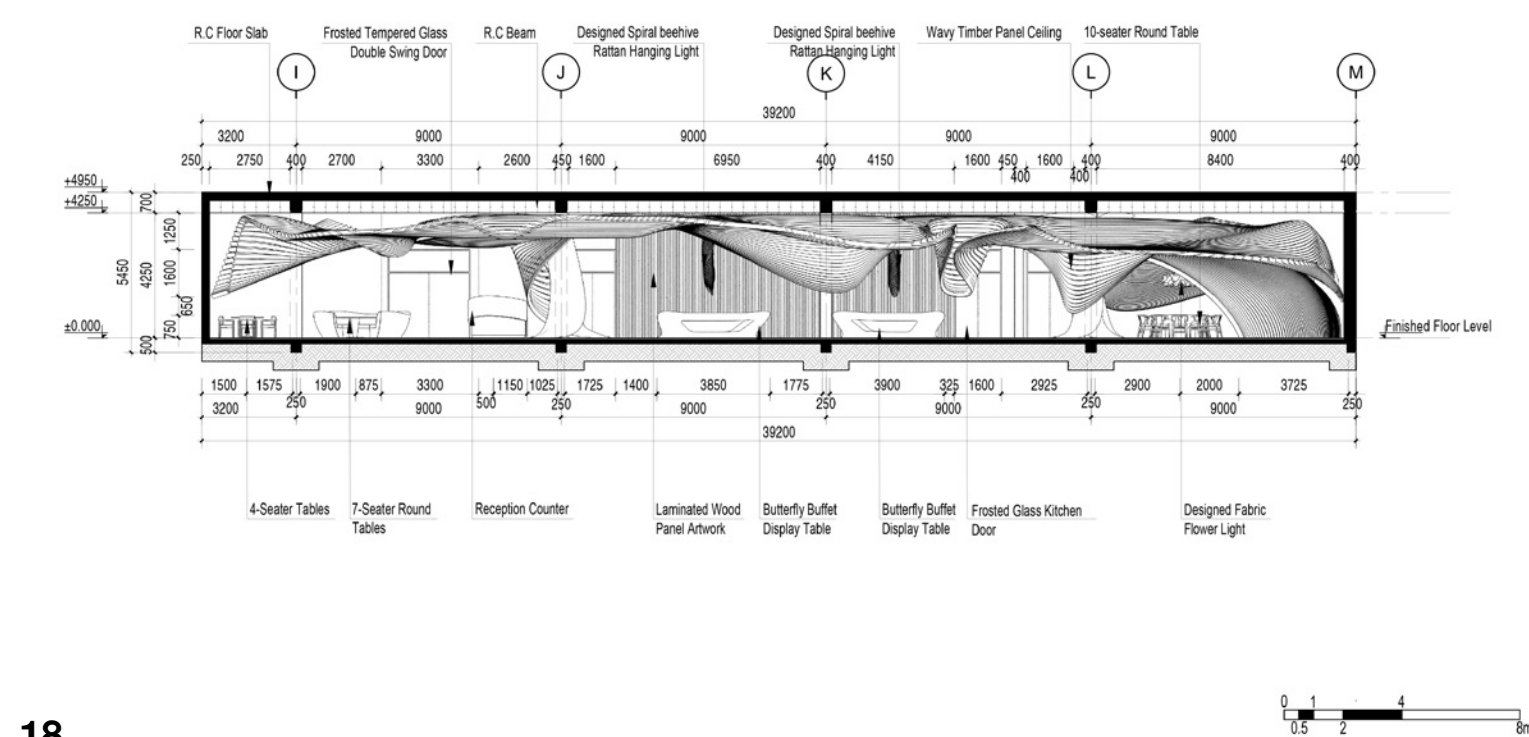
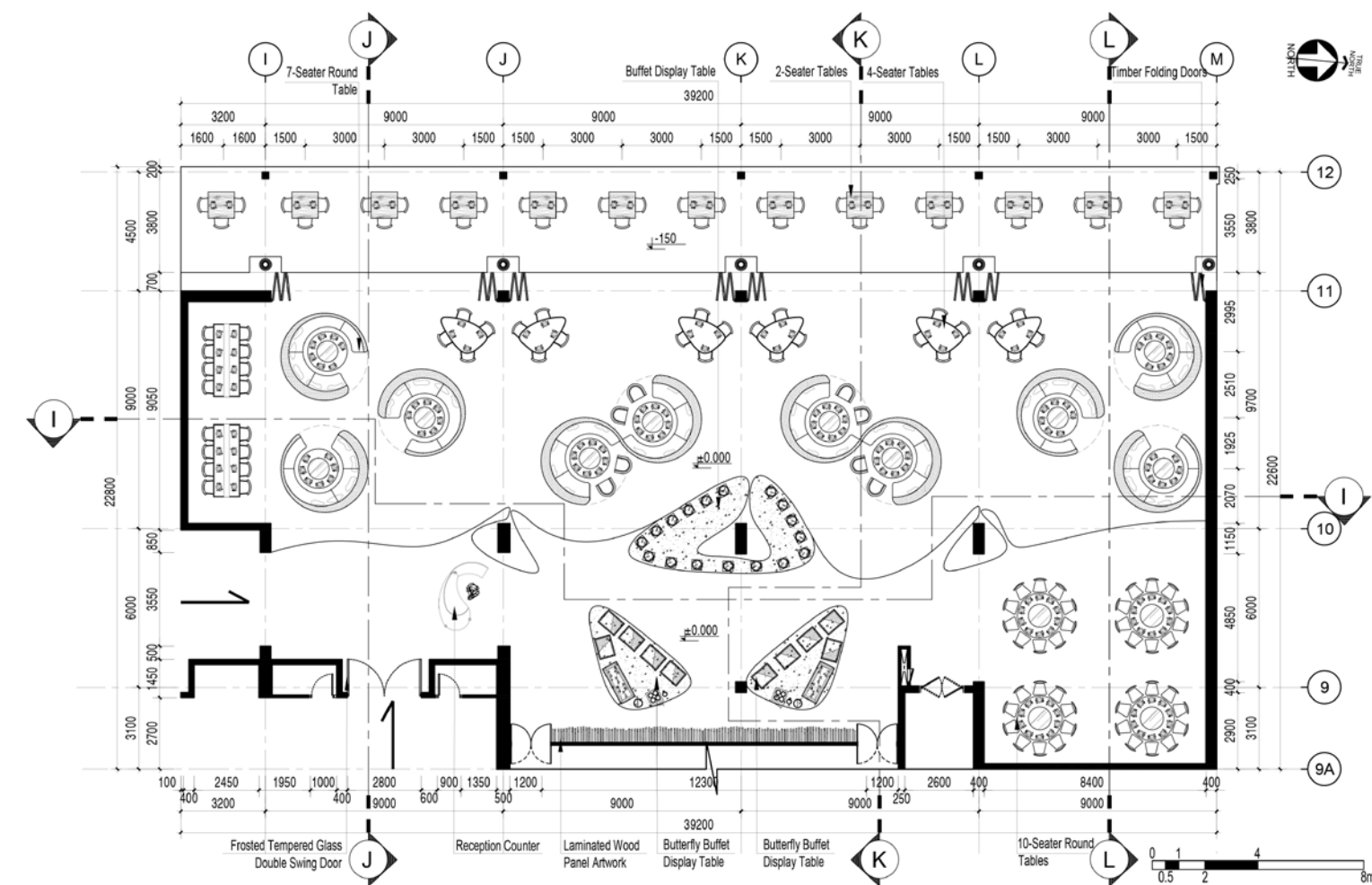







Lounge Bar

A bit different from the previous designs, lounge bar is inspired by magnificent terrace fields mixing bee hexagons and rhythms ceiling as the sky which fill up the far-away majestic mountains. Furthermore, contrast color pairs are utilized by green and yellow to create an unforgettable impress at the first sight.

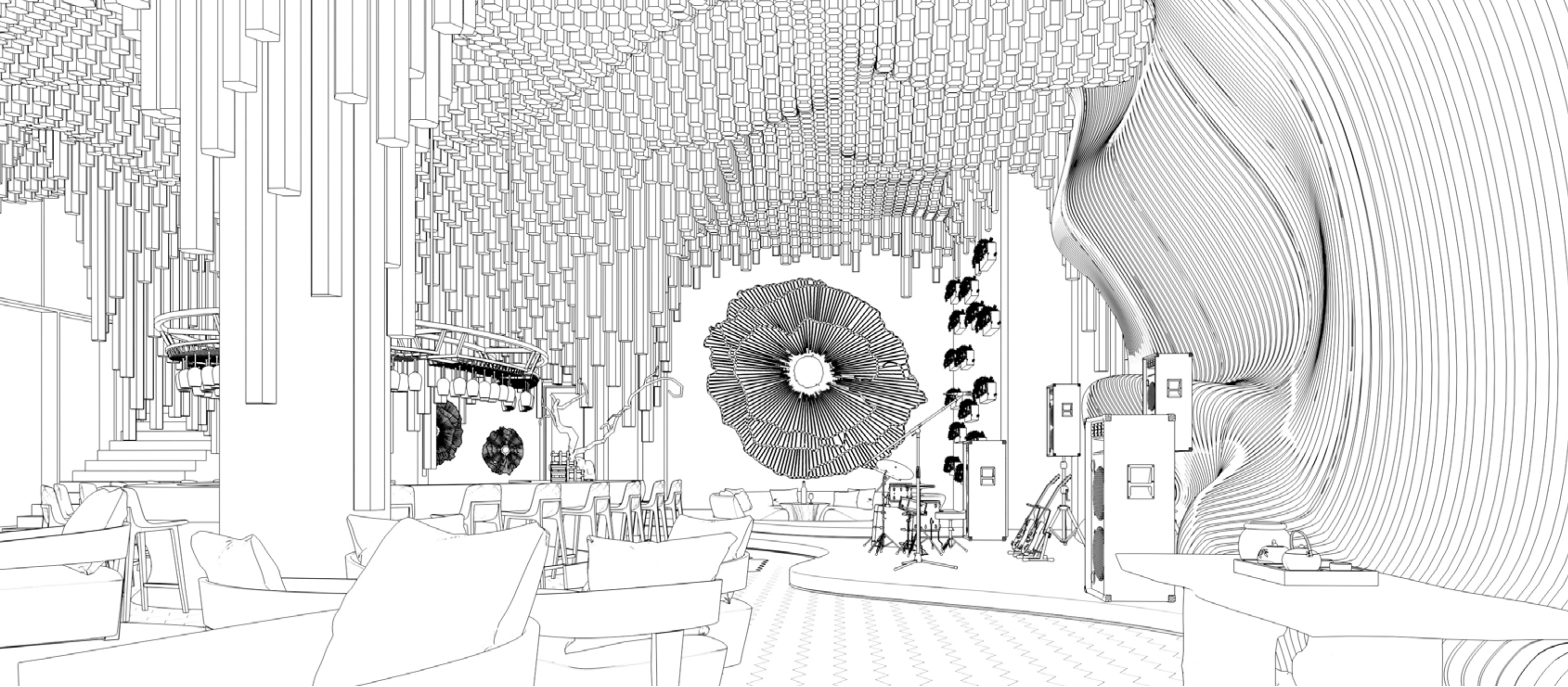
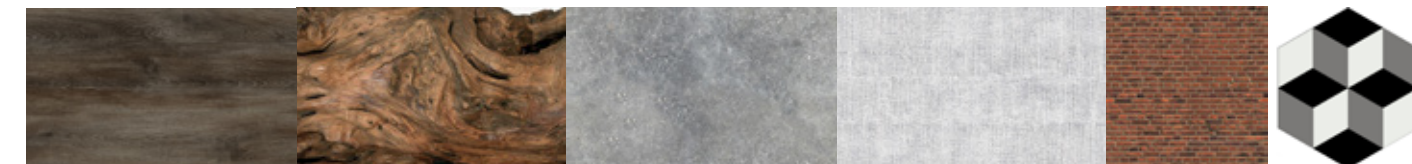

This feature is simplified as a top view of a typical terraced rice field.

The ceiling form demonstrates the sky which subtracts the mountain shapes to create a flow in the sky.



DESIGN ANALYSIS

This panel illustrates the mountains which arranged layer by layer away.

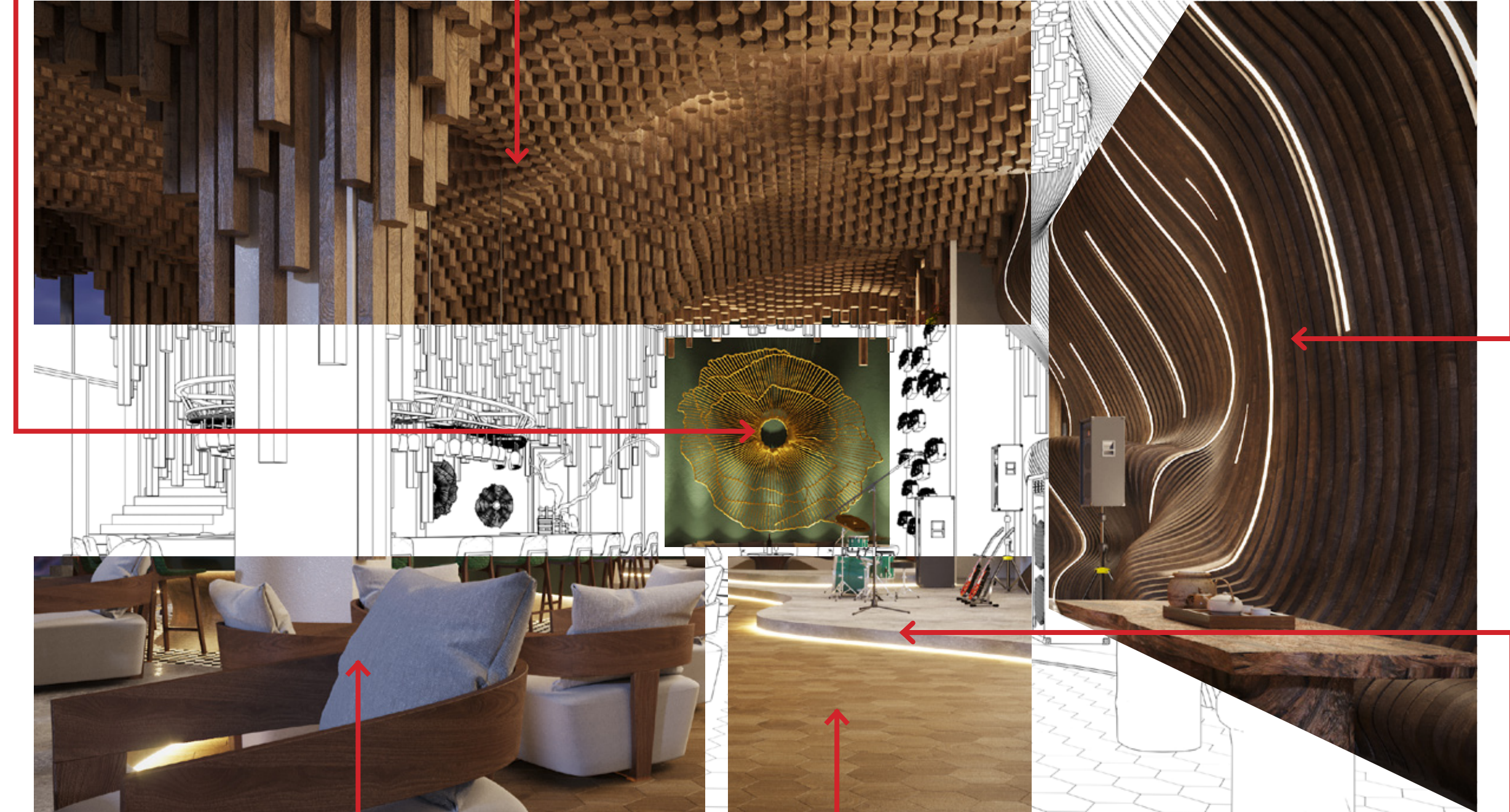

Minimalist furnitures were utilized in contemporary style.

The wooden floor demonstrates a valley between two terraced rice fields. The hexagon tile is a symbol of bee species which are well-known as the most diligence in the animal kingdom.

the rised up floor level with curves was created to follow terraced field shapes.

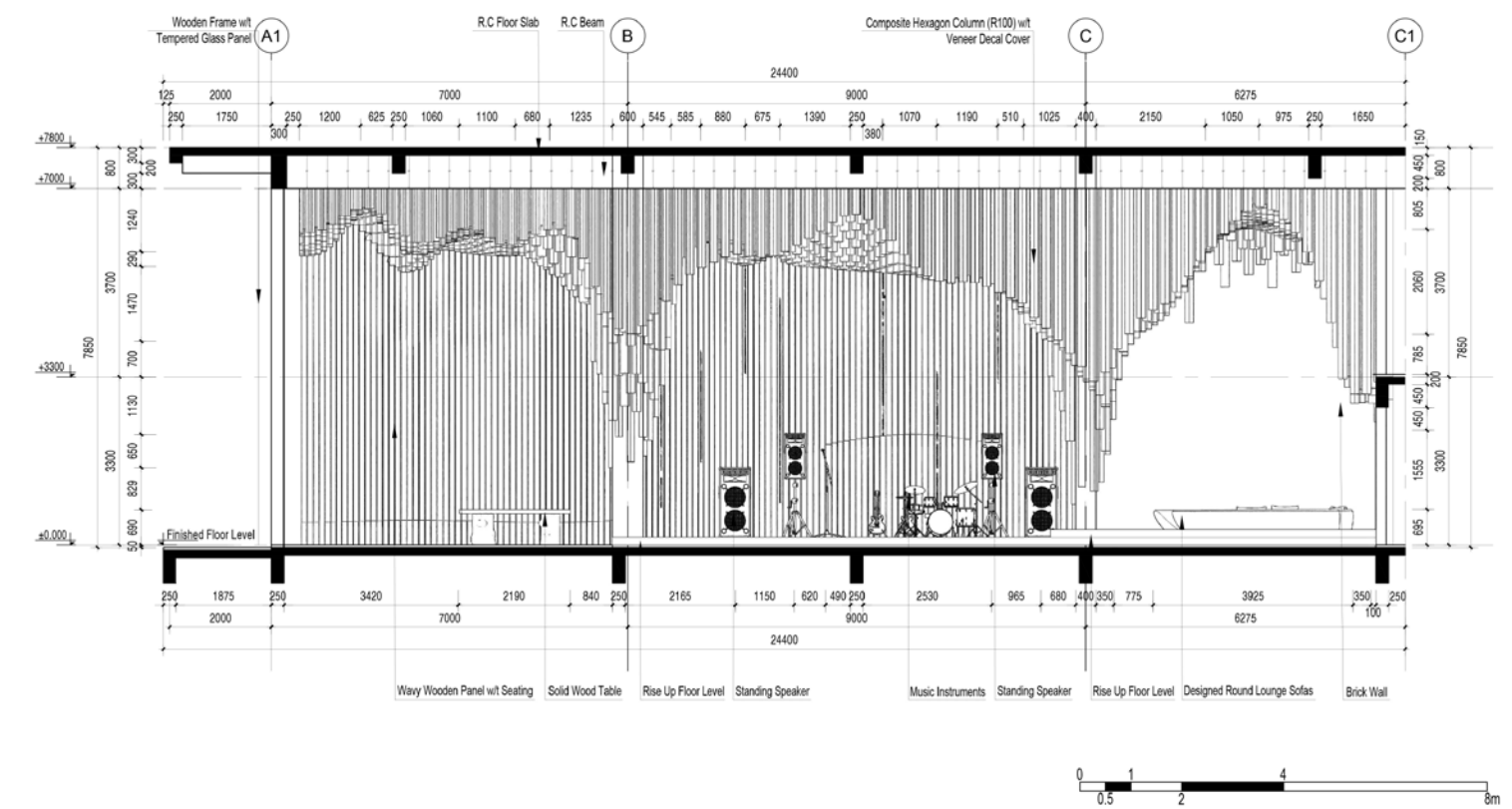
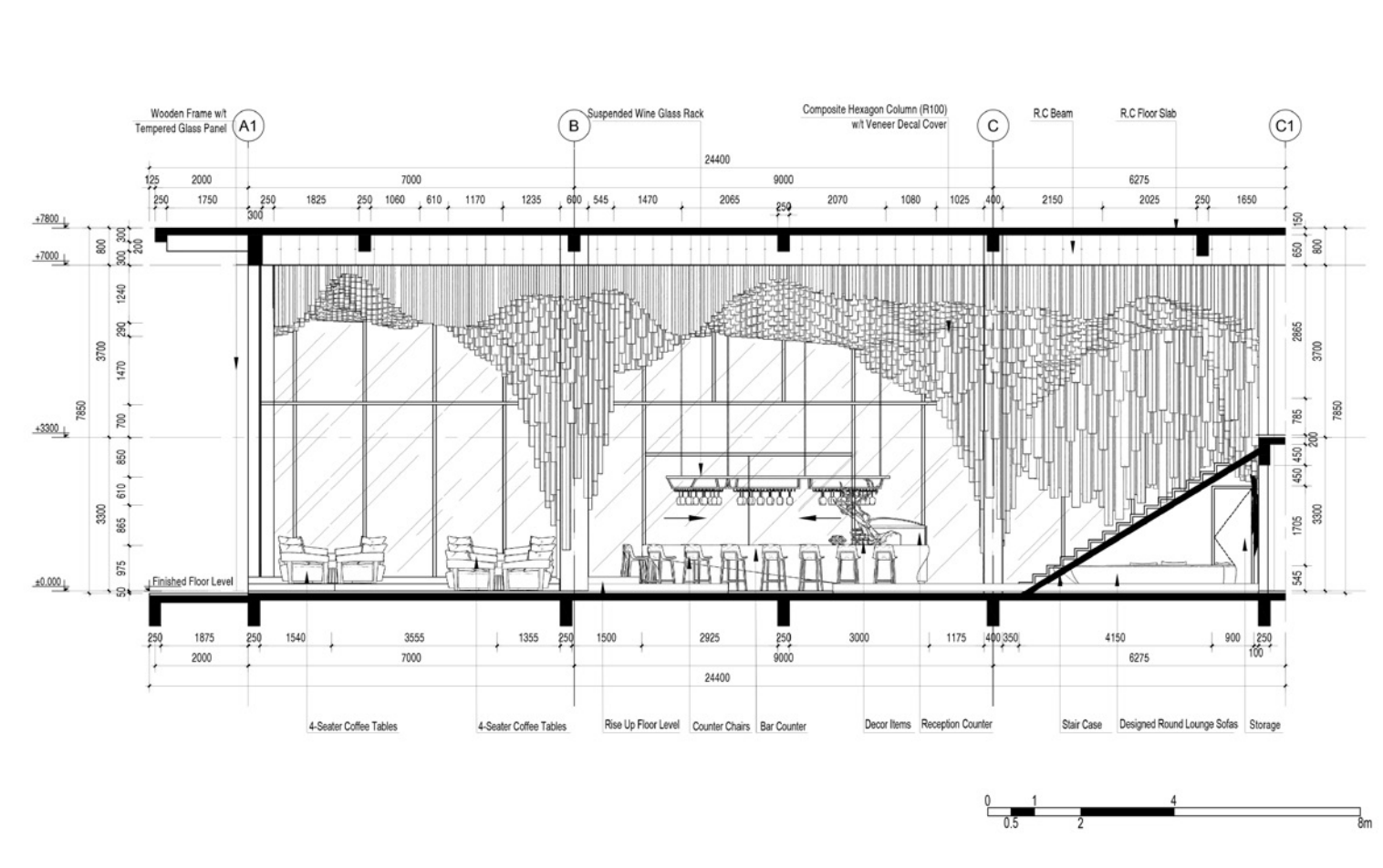
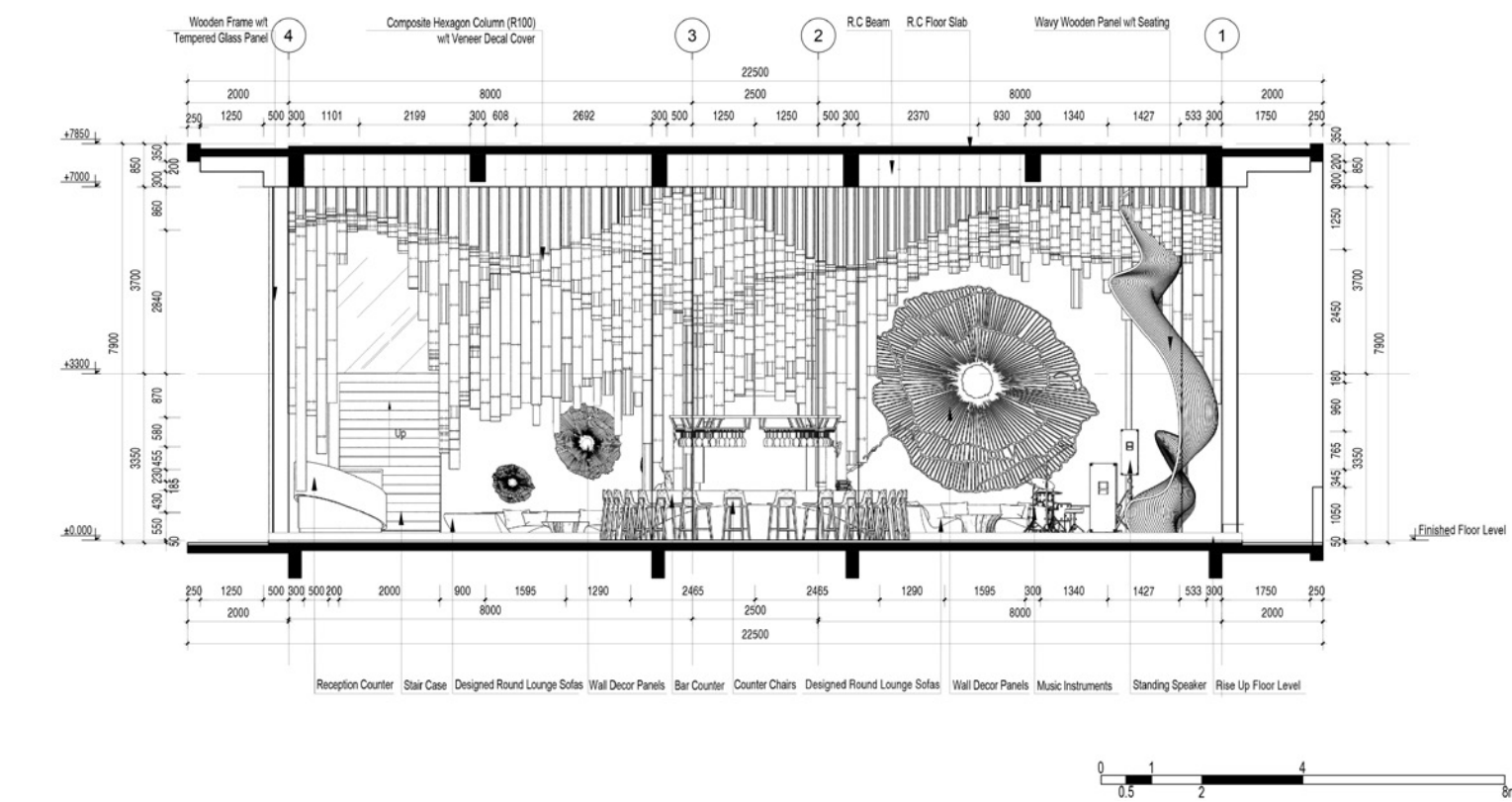
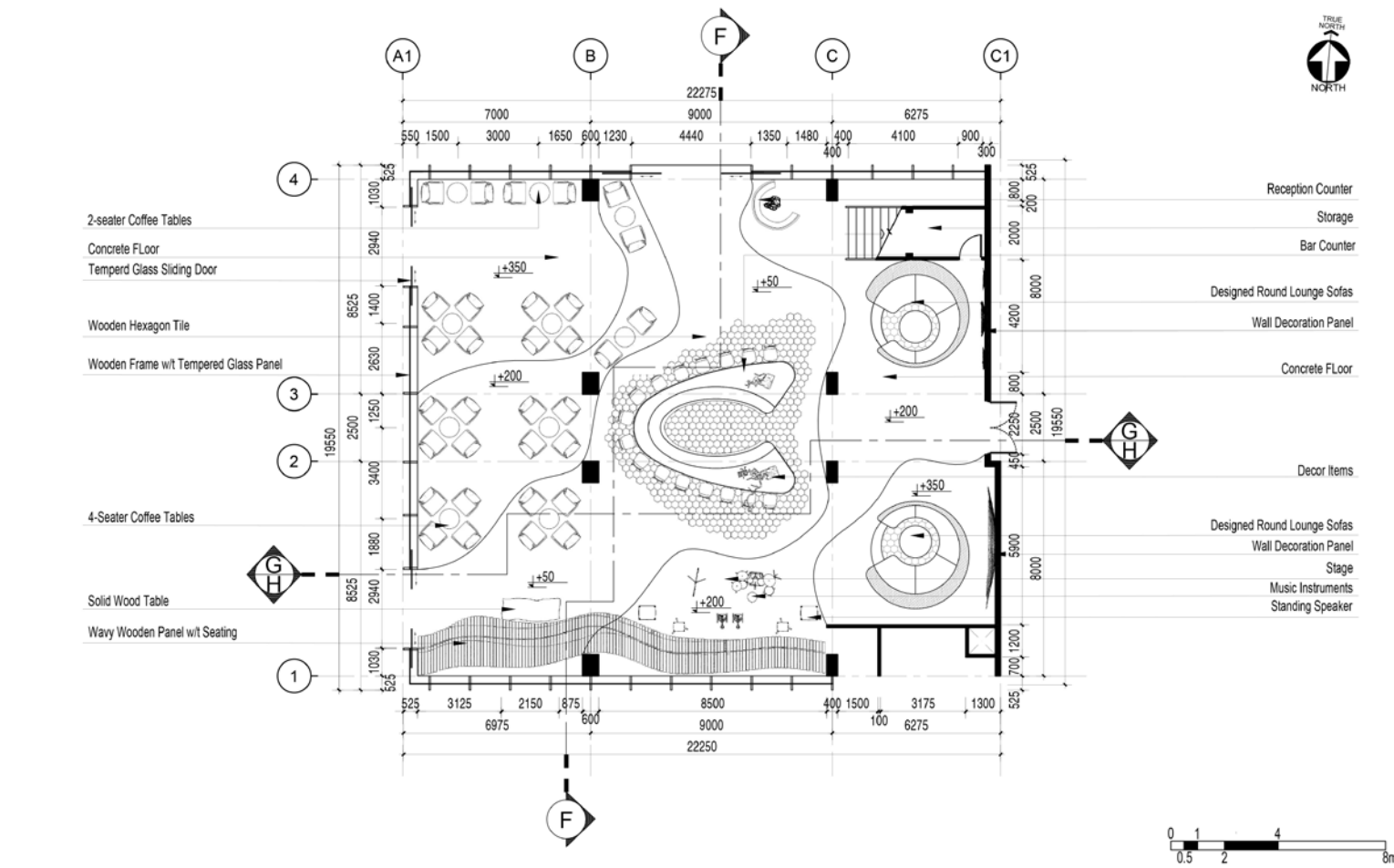



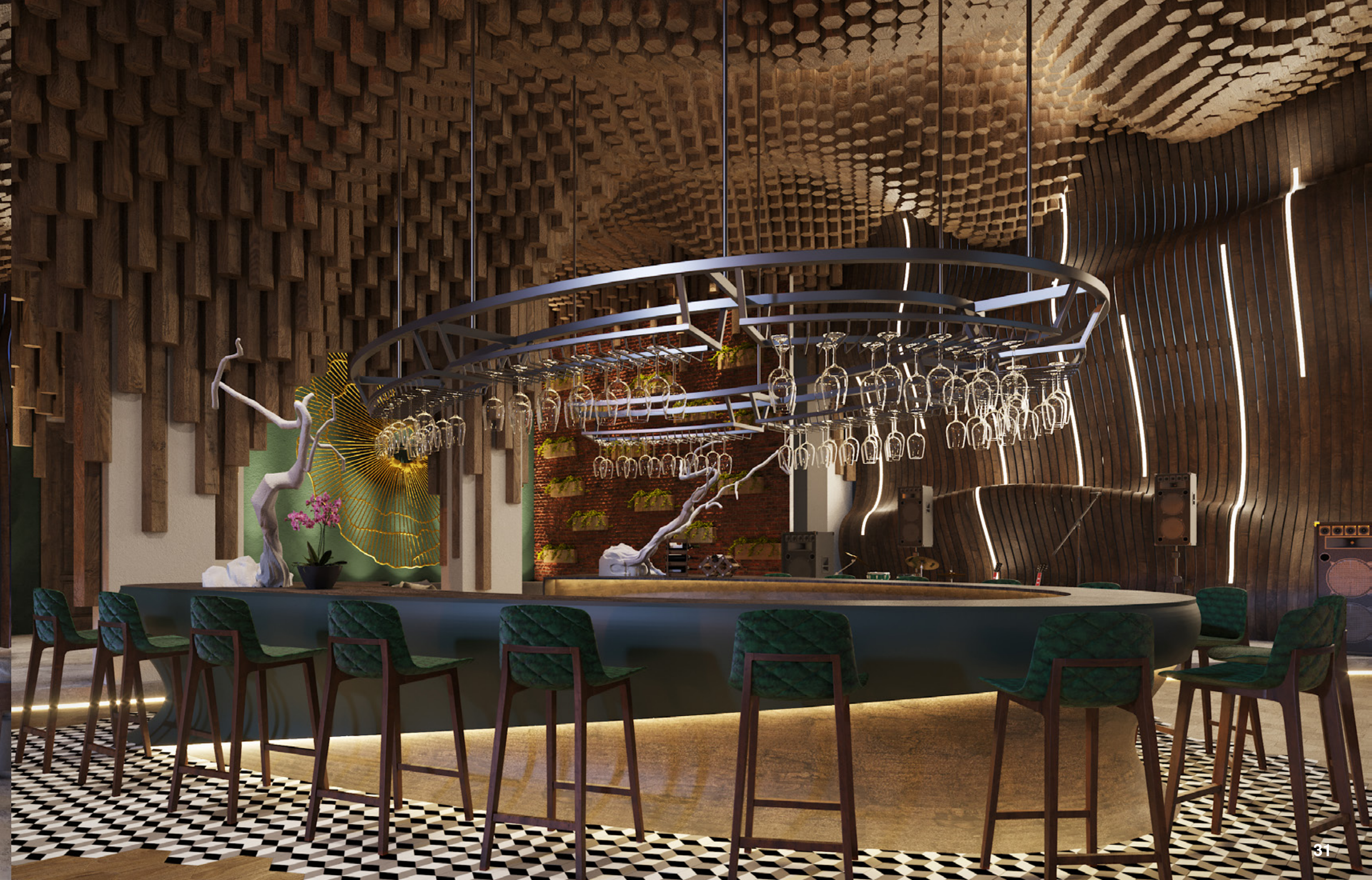

The eye of nature

Broaden your mind

Interior designing & visualizing

Project type: Retail design
Location: Sa Pa, Vietnam
Date: January, 2018

This is my project which i was designing in exhibition & retail design subject.

The design is inspired deeply by a huge variety of breath-taking landscapes through the majestic mountains, the stunning terraced fields, the eco-friendly atmosphere everywhere in Sapa, Vietnam. Wishing to bring the horizons to local residents through the priceless books of the designer as well as to inspire the people who can be approach to global knowledge, the design follows the guide that must be environmentally-friendly, simple and familliar with the readers. Last but not least, it can be an ideal place exhausted, tired people who really want to escape from daily life routines.

Dragon Jaw Mountain

Sa Pa, Vietnam



Objectives

Dragon Jaw is a small mountain loacates near Sapa towncenter. As the name suggested, Dragon Jaw mountain has a part of the mountain that shapes the jaw of a dragon. It's also a part of Hoang Lien Son mountain range. The surrounding of Dragon Jaw is mainly forrest, however it's an attraction for tourism and local people to get by. Beneath the mountain is a small garden as a welcoming entrance to lead people into the place.

Location

Sa Pa - Vietnam

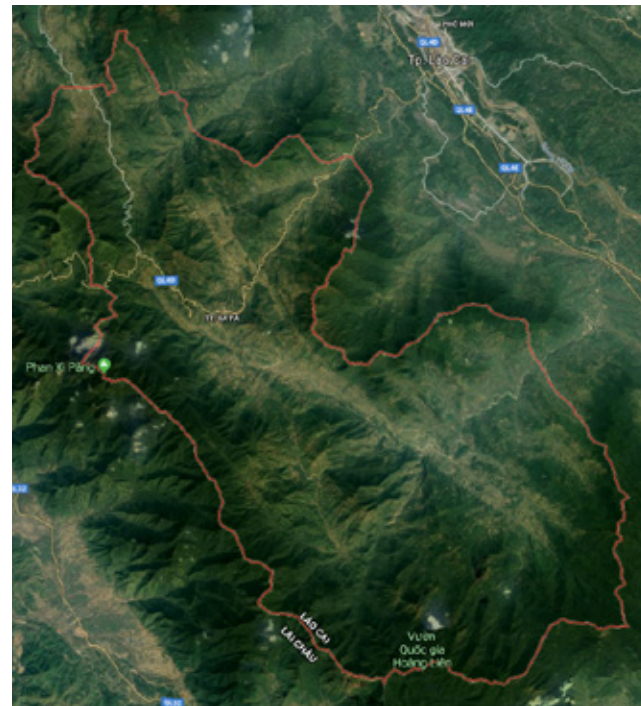

Sa Pa is a quiet mountain town and home to a great diversity of ethnic minority peoples. The total population of 36,000 consists mostly of minority groups. Besides the Kinh (Viet) people (15 percent) there are mainly five ethnic groups in Sa Pa: Hmong 52 percent, Dao 25 percent, Tay five percent, Giay two percent, and a small number of Xa Pho. Approximately 7,000 live in Sa Pa, the other 36,000 being scattered in small communes throughout the district.

Most of the ethnic minority people work their land on sloping terraces since the vast majority of the land is mountainous. Their staple foods are rice and corn. Rice, by its very nature of being a labour-intensive crop, makes the daily fight for survival paramount. The unique climate in Sa Pa has a major influence on the ethnic minorities who live in the area. With sub-tropical summers, temperate winters and 160 days of mist annually, the influence on agricultural yields and health-related issues is significant.



Moodboard



Material broad



Bubble diagram

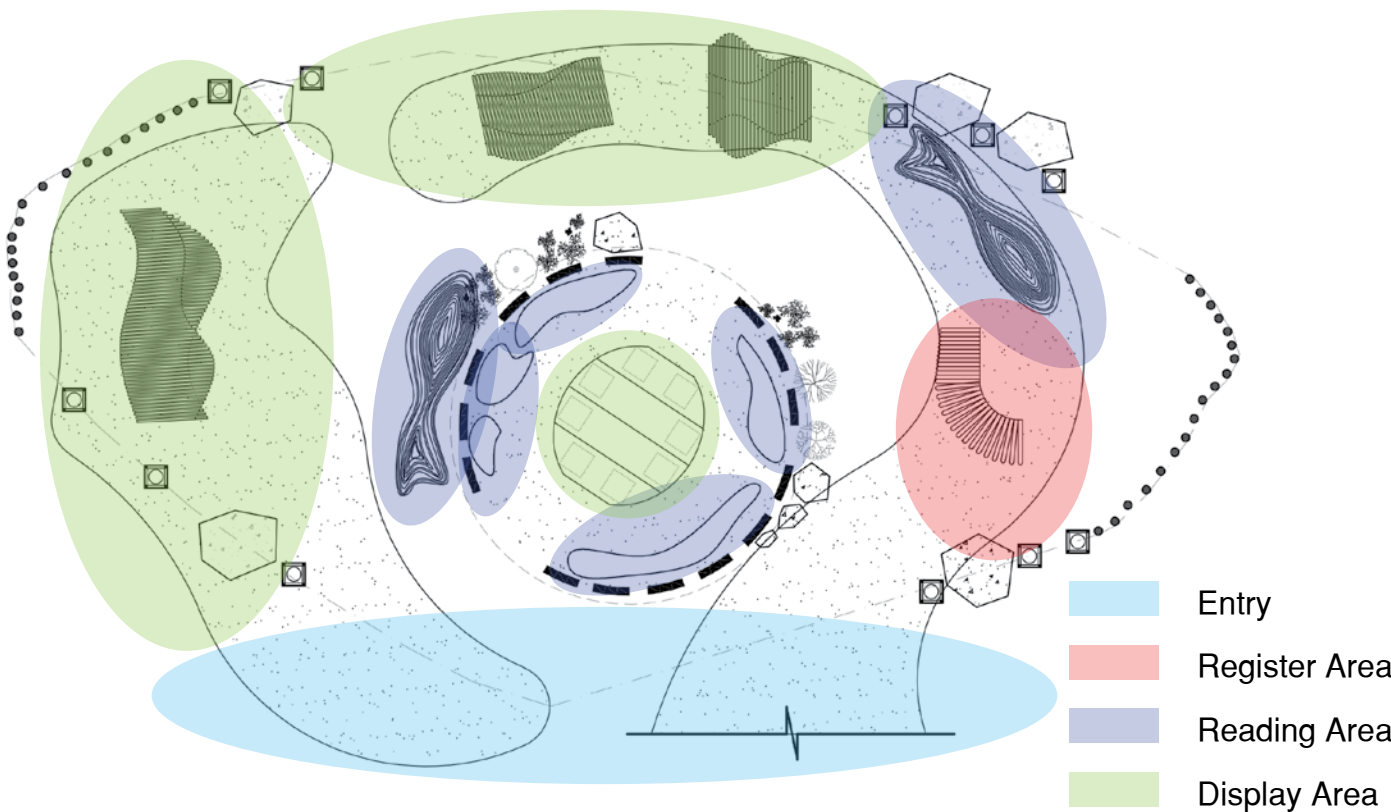

Circulation plan

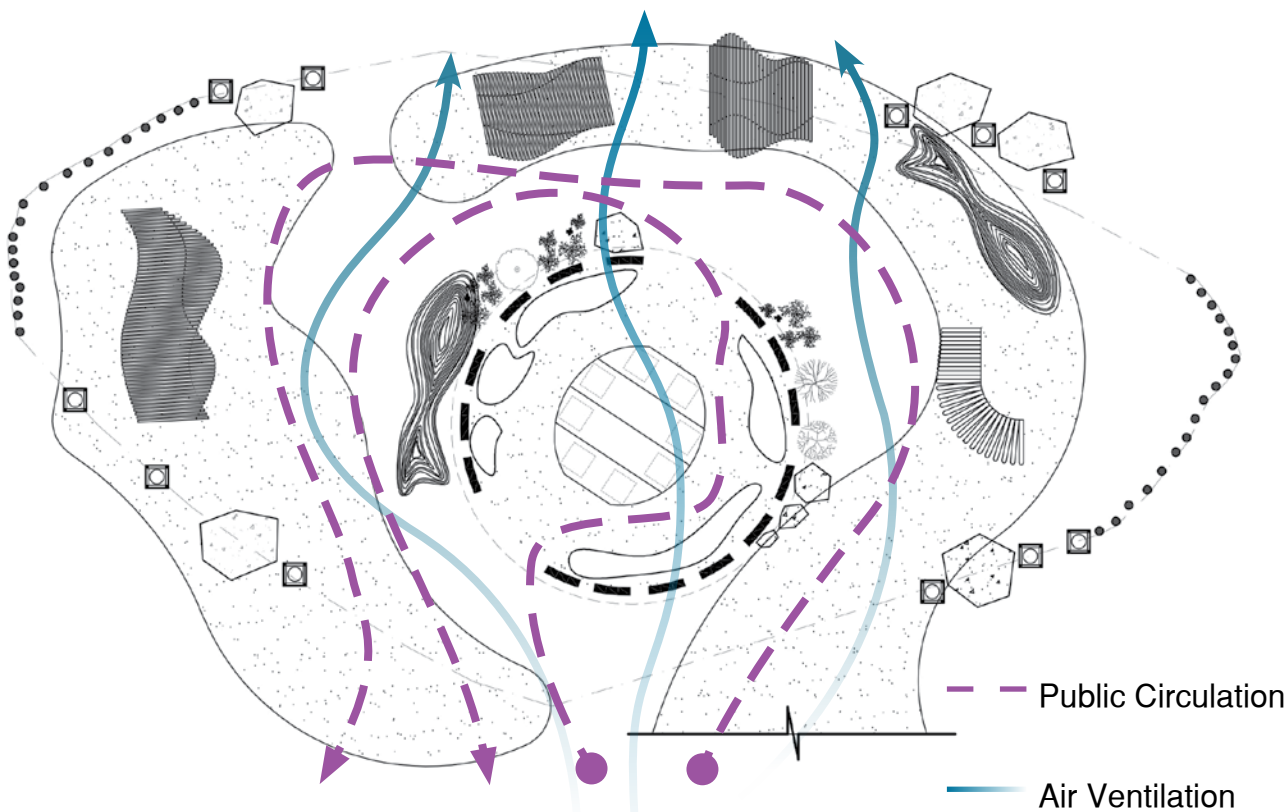

The typical concept starts at wing and human eye shapes which stand for desire of gaining knowledge. The dual bamboo wings covered around bamboo ball to create an eye shape in front and even top view. There are two kinds of bamboo, elder and young one. That demonstrates a connection conveying knowledge through books between young and aged generation.

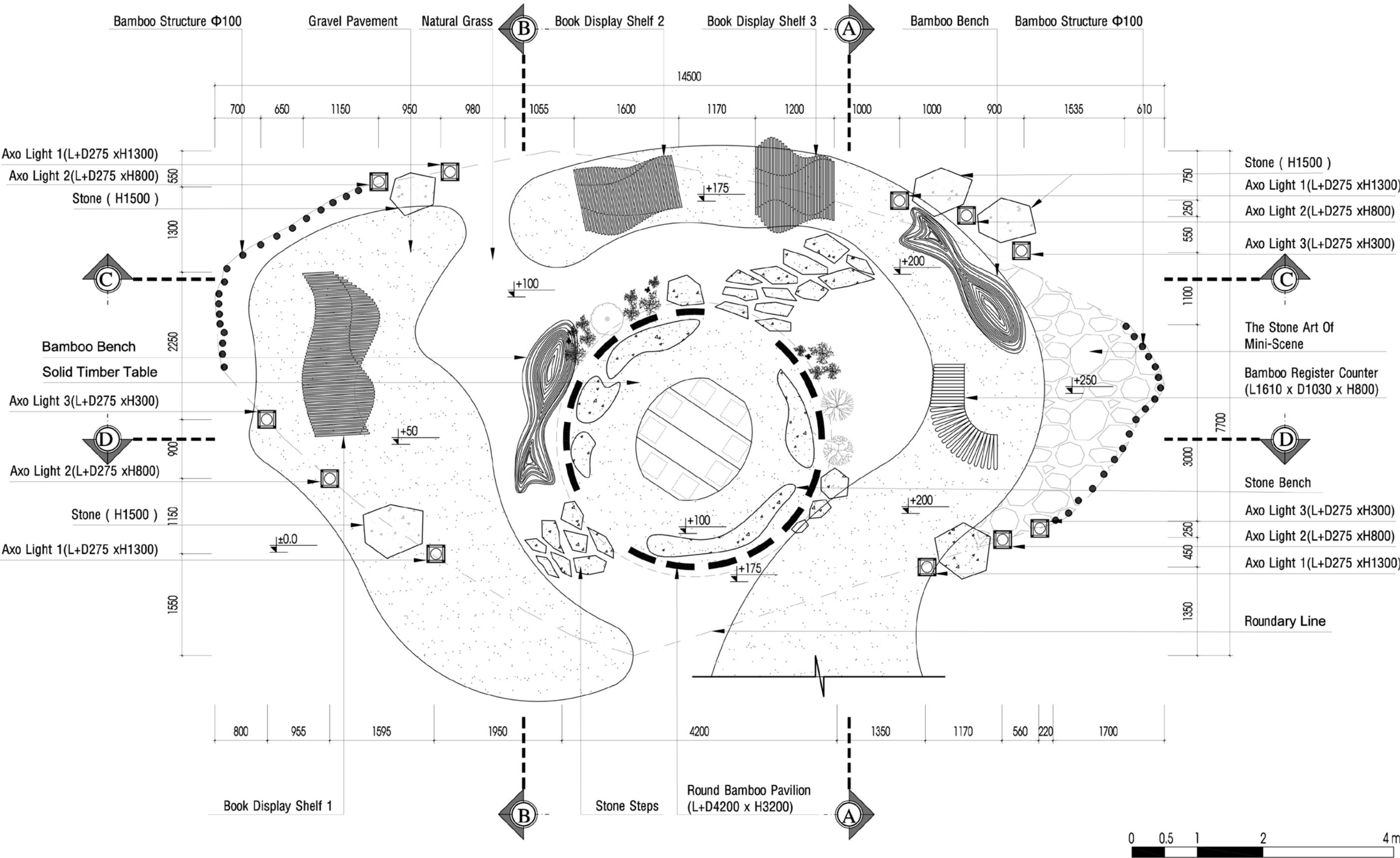
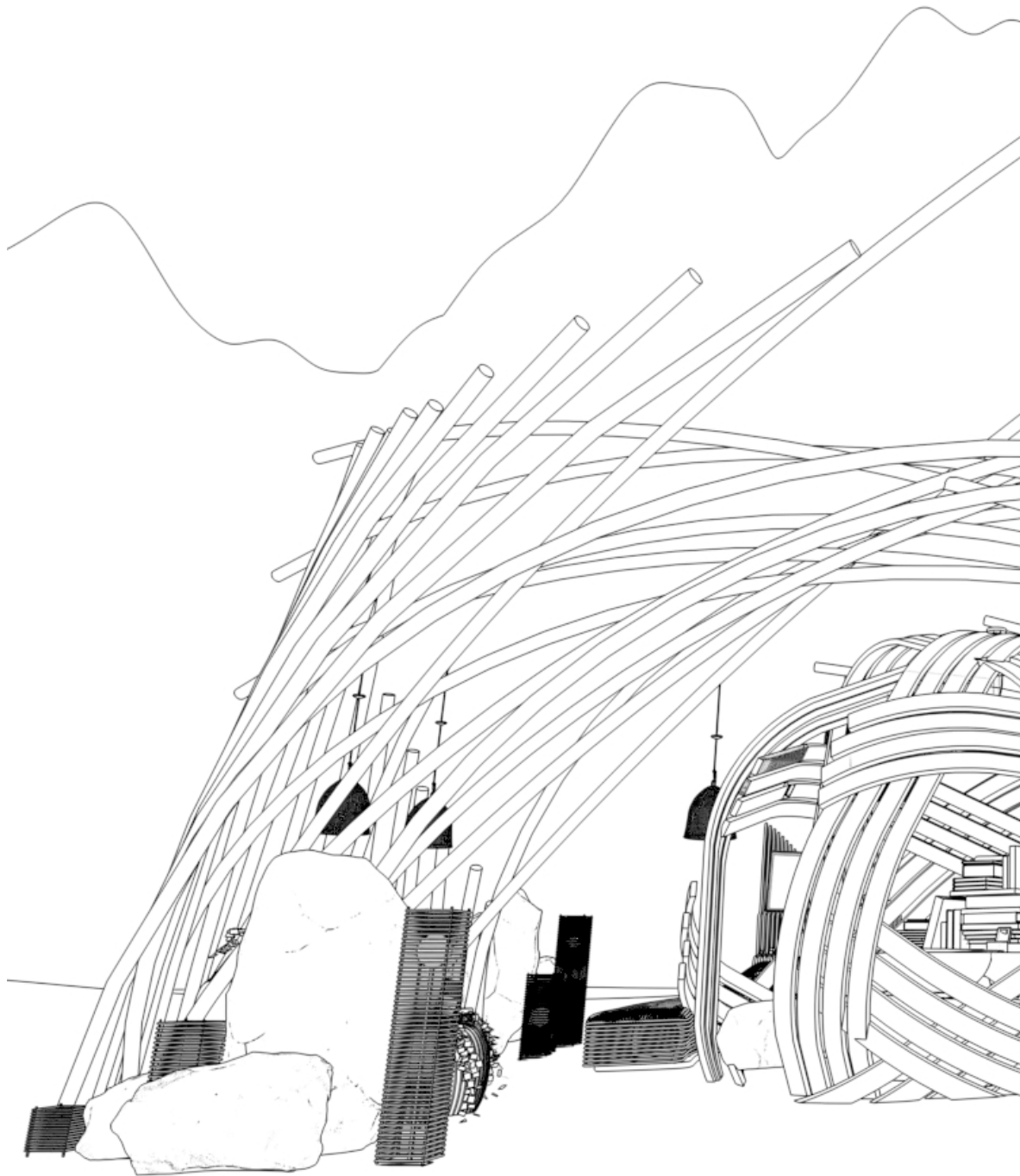

PROJECT TITLE: BOOK STORE EDEXCEL 6 - ID UNIT 101: EXHIBITION & RETAIL DESIGN	DRAWING TITLE: PROPOSED FLOOR PLAN	Drawn by Checked by Scale Date Drawing No.	Le Khanh Cat Tuong Michael Ling - January 2018 001	NOTES 1. This drawing and concept contained therein are and remain the property of LE KHANH CAT TUONG and shall not be copied or used in whole or part without the written consent of LE KHANH CAT TUONG. Any breach of this condition shall be deemed to be a breach of copyright. All rights reserved. 2. All specification and dimension to be verified on site before commencement of any works. Any discrepancies must be reported to the respective designer immediately for further clarification. Corrections are advised to clarify all site measurement and shop drawings are not to be scale for construction purposes. Otherwise the contractor must bear all the responsibilities.	CLIENT HAS REVIEWED AND APPROVED. CLIENT SIGNATURE & DATE	COMMENTS: 	
---	--	--	--	---	--	-------------------	--

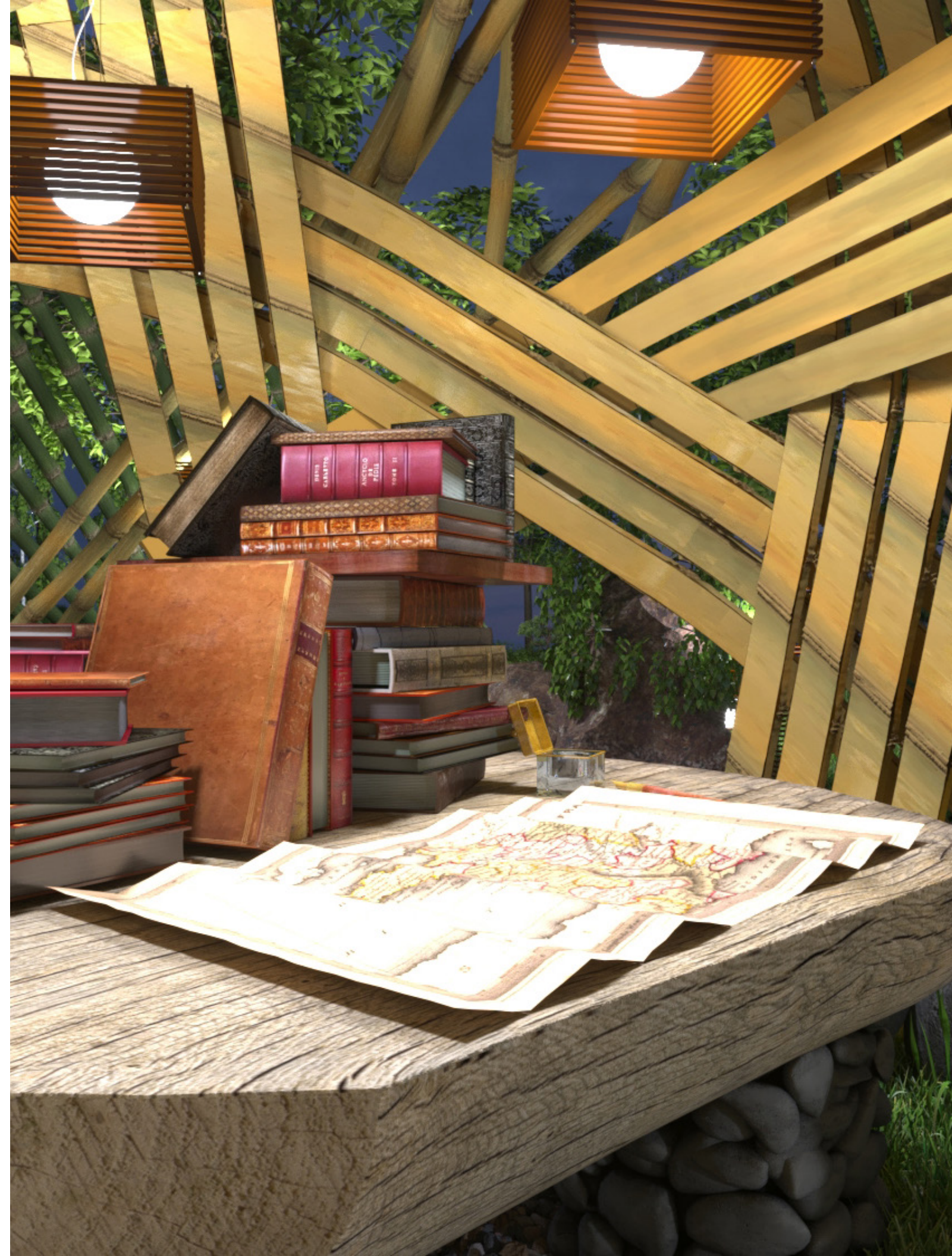
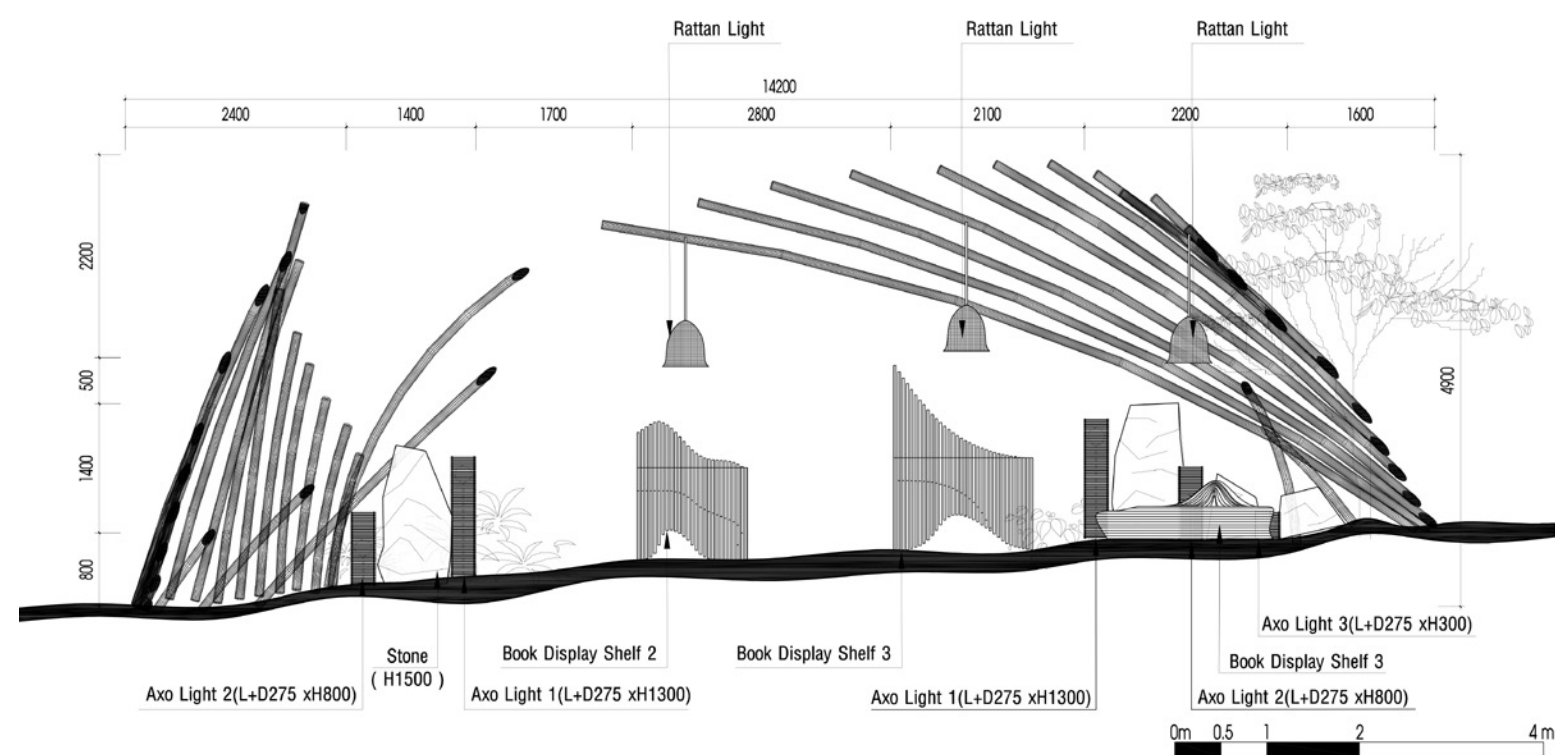
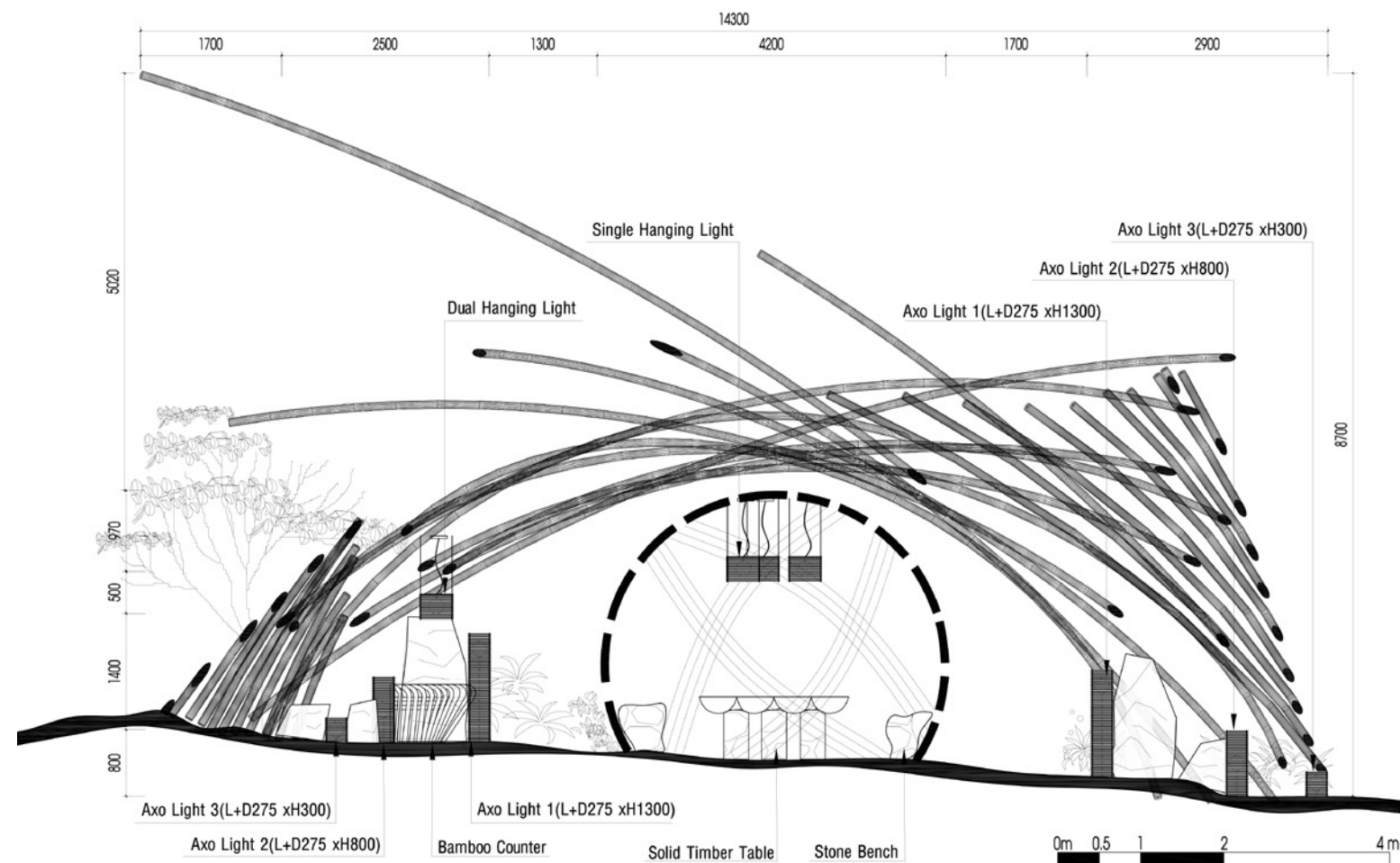



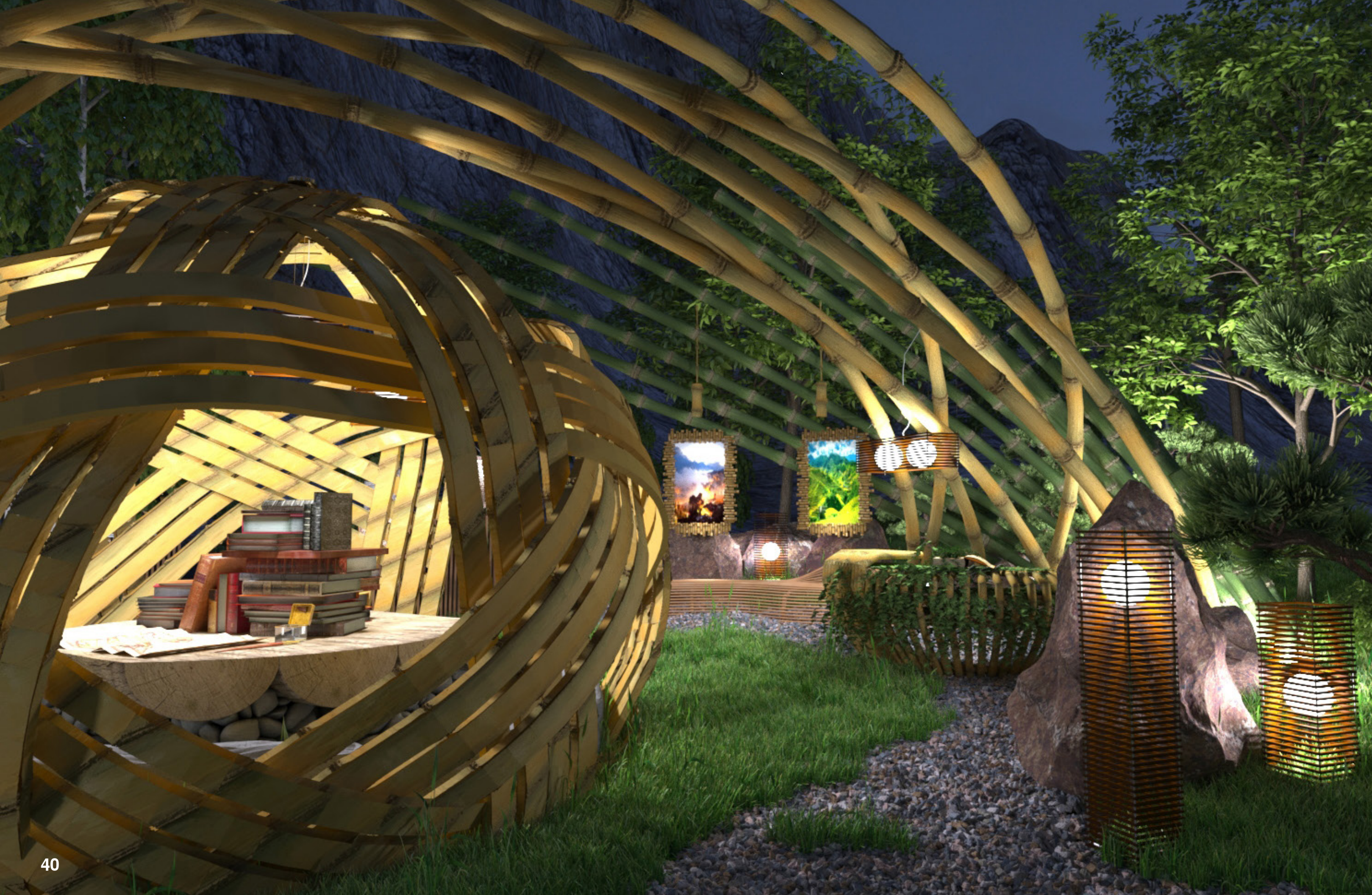

The Gentleman Perfume

Product Design

Project type: Product Design

Location: ...

Date: June, 2017

The perfume is inspired by gentleman spirit with the typical shape after sketching several versions under many different concepts. It is emphasized by black glass inside to create an contrast impression at the first sight.

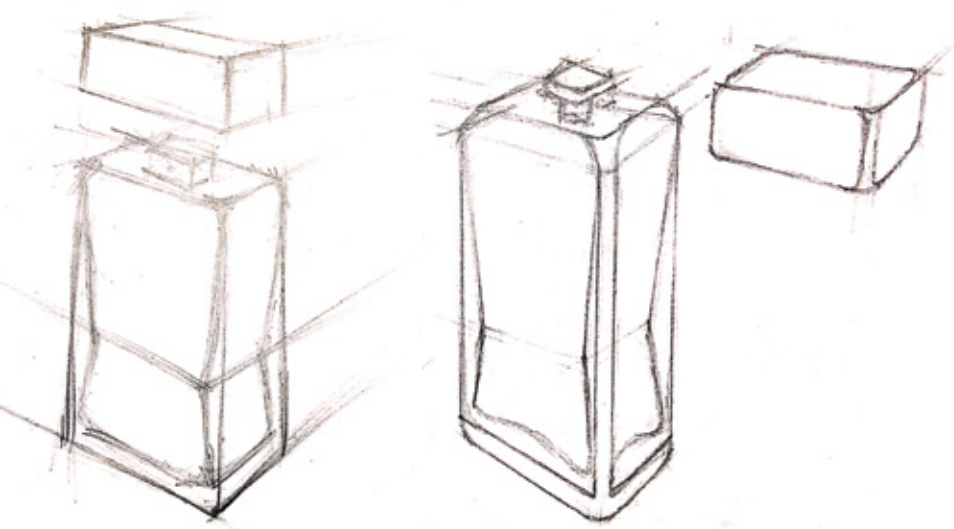
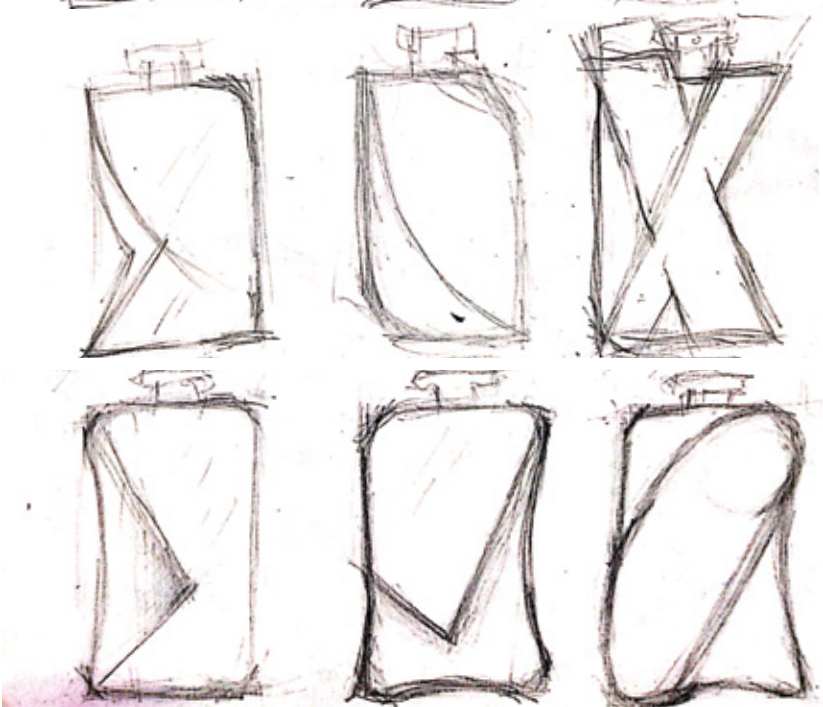

General Sketching



Inspiration

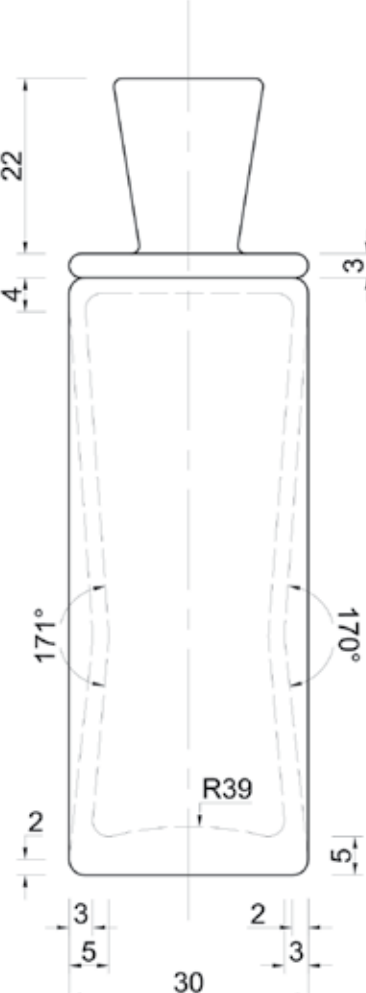
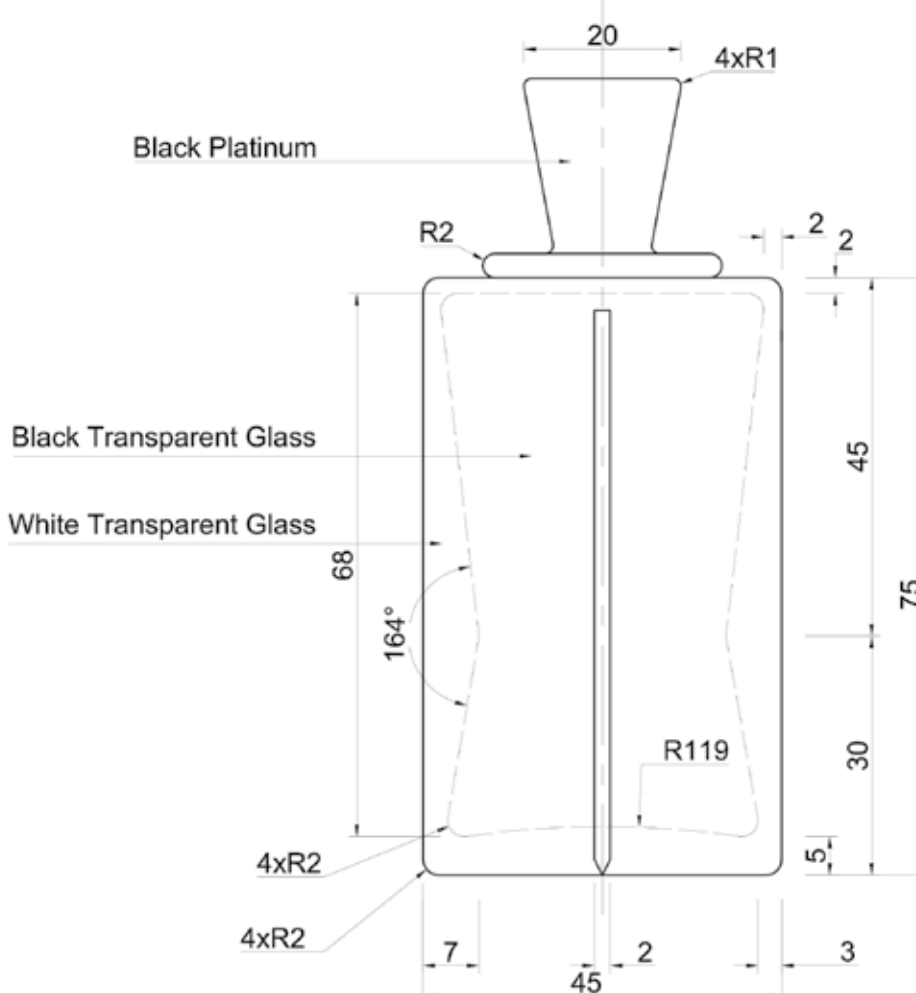
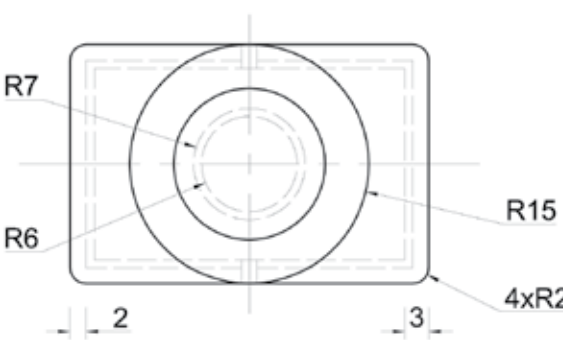

Technical Drawing



Final Product

The Perfect House

Exterior visualizing

Project type: Residential Project- Villa
Location: UK
Date: March, 2019

I had an opportunity to do this job for an UK client which was about providing an architecture visualization images from pre-made plans and many references

I have took this challenge which I believed it could be a great experience. By visualizing the project, my responsibility and visualization technique skills could be significantly improved beside aesthetic awareness and material properties. Additionally, I could learn many things about UK climate, culture and daily life routines, particularly architecture.



FDEV_02

Interior designing & visualizing

Project type: Residential design
Location: Israel
Date: August, 2018

The general concept was modern style according to the client's references. The whole project have two buildings namely FDEV_01 and FDEV_02. Each building have ground floor, typical floor and penthouse space. I decided to design the typical floor of building FDEV_02 in team. The most difficult part was co-workers and I had to do a similar design for the entire building. Therefore, we followed each other very closely and shared the information together. That was really interesting experience.

